

Test Reuse Based on Adaptive Semantic Matching across Android Mobile Applications

Shuqi Liu¹, Yu Zhou^{1,*}, Tingting Han², and Taolue Chen²

¹College of Computer Science and Technology, Nanjing University of Aeronautics and Astronautics, Nanjing, China

²Department of Computer Science and Data Science, Birkbeck, University of London, UK

{liushuqi, zhouyu}@nuaa.edu.cn, {t.han, t.chen}@bbk.ac.uk

*corresponding author

Abstract—Automatic test generation can help verify and develop the behavior of mobile applications. Test reuse based on semantic similarities between applications of the same category has been utilized to reduce the manual effort of Graphical User Interface (GUI) testing. However, most of the existing studies fail to solve the semantic problem of event matching, which leads to the failure of test reuse. To overcome this challenge, we propose TRASM (Test Reuse based on Adaptive Semantic Matching), a test reuse approach based on adaptive strategies to find a better event matching across android mobile applications. TRASM first performs GUI events deduplication on the initial test set obtained from test generation, and then employs an adaptive strategy to find better event matching, which enables reusing the existing test. Preliminary experiments with comparison to baseline methods on 15 applications demonstrate that TRASM can improve the precision of GUI event matching while reducing the failure of test reuse and the running time required for test reuse.

Keywords—adaptive semantic matching; android mobile applications; GUI event; test reuse; oracle generation

I. INTRODUCTION

Graphical User Interface (GUI) testing is commonly employed to verify and develop the behaviors of applications by designing and executing test cases of GUI applications [1]. However, with the ever increasing functionalities in mobile applications, it takes more effort for developers to manually design GUI test cases (GUI test in short) [2–4], which in turn decreases the efficiency of testing processes.

Considering the necessity of reducing time consumption, many researchers have conducted a series of investigation on automatic test generation [5–15] in GUI testing. Recently, some researchers observed that test reuse [16–24] could be achieved by exploiting the semantic similarity of GUIs between similar applications to generate tests automatically. Figure 1 shows a simple example in which the existing test (a) of application *To-Do List* is successfully reused to application *Minimal*, and the reused test (b) is obtained. As Figure 1 shows, events e_1^m , e_2^m , e_3^m , and e_4^m in test (b) are similar to e_1^t , e_2^t , e_3^t , and e_4^t in test (a), respectively.

Existing research mainly focuses on how to accurately select specific characteristics of widgets in GUIs such as ‘text’ and ‘resource-id’. Combining the selected characteristics, they design the semantic similarity calculation method between widgets to generate meaningful tests. They attempt to select widgets with high similarity in a similar application for matching each event of the existing test. However, little attention has been paid to optimizing the matching process. Taking Figure 1 as an example, the widget w_3^t of *To-Do List* and

the correctly similar widget w_3^m of the application *Minimal* are laid out differently in the GUI. When reusing test (b) to the application *To-Do List*, adopting the existing approach may always incorrectly match the widget w_3^m with other widgets. This may cause subsequent events to match incorrectly or even result in failed test reuse. In cases where the existing methods do not work well, it is necessary to adopt other corresponding measures. The lower the similarity of the generated event, the more likely the match is inappropriate. Hence, mining such events and exploring other widgets with more similar semantics to form events for substitution is considered.

In addition, in Figure 1, the application *To-Do List* needs to skip the boot page that the application *Minimal* does not before entering the home page. And it is assumed that the event step is $e_0^t = click(w_0^t)$. Under this assumption, the widget w_0^t will match the widget with the highest similarity on the home page of the application *Minimal*. Obviously, the event produced by this step is redundant in the generated test. This simple example explains that we need to solve the event redundancy issue in the process of test reuse caused by some particular functionality in the existing test.

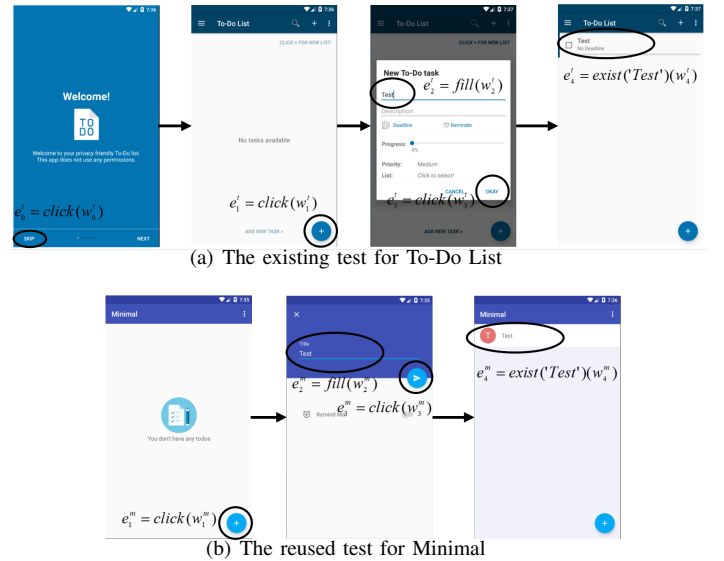

Figure 1. A simple example of test reuse. The test (b) is obtained by reusing the existing test (a).

Inspired by the above observation, in this paper, we propose a novel approach TRASM (Test Reuse based on Adaptive Semantic Matching) to reuse the existing tests across android

mobile applications. In addition, we carry out comparative experiments with the-state-of-the-art baseline approaches to evaluate our work. Overall, our main contributions are as follows:

- 1) We propose a novel approach TRASM, which utilizes an adaptive strategy to reuse more existing tests. TRASM can get more semantic matches in the generated test.
- 2) TRASM includes a GUI events deduplication method, which could eliminate duplicated events caused by reusing particular functionality contained in the existing test to improve the quality of the generated test.
- 3) We carry out extensive experiments which confirm that TRASM improves the accuracy of GUI event matching while reducing test reuse failures and reduces the running time required for test reuse.

The rest of this paper is organized as follows. Section II introduces related work. Section III describes the main idea and the proposed approach in detail. Section IV carries out experimental evaluation. Finally, Section V concludes the paper and outlines future research.

II. RELATED WORK

A. Test Generation

In order to improve the efficiency of developers, based on different exploration strategies, several studies on automatic test generation have been proposed, which has laid a solid foundation.

Sapienz [5] combined random fuzzing, systematic and search-based exploration, exploiting seeding and multi-level instrumentation to explore and optimize test sequences automatically. Gu et al. [7] dynamically abstracted the model by leveraging decision tree-based representation and updated the model by utilizing the evolution mechanism, which balances the accuracy and size of the model. ConmboDroid [15] obtained the use cases for verifying the unique functions of the application and then systematically enumerates and combines them to generate higher quality input. The advantage of their work is that they can mine more hidden bugs or achieve as high coverage as possible. Nevertheless, the test generated by their method is seldom standardized for verifying the application's functionality.

Different from their purpose and inspired by their exploration method, we focus on generating more meaningful tests based on semantic information.

B. Test Reuse

Test reuse, as an alternative method to automatically generate GUI test, makes full use of existing resources to provide convenience for verifying the application's behavior.

Lin et al. proposed CRAFTDROID [19], an approach of test transfer across applications, which utilizes the GUI model extracted by static analysis to match event sequences similar to the semantics of the existing test in order. They realized the successful transfer of GUI and oracle events, which guides for improving test transfer. To more accurately express the similarity of widgets in test events, Mao et al. [20] raised a

semantic-based event fuzzy mapping strategy when matching candidate widgets to generate target events. They always greedily preferentially explore and match the widgets with the highest similarity. Unfortunately, when their similarity calculation method does not work well, the correctness of event matching will be threatened. Considering that the success of test reuse heavily depends on the semantic matching of test events, there is still space for improvement by adopting appropriate strategies to increase the quality of reused tests from the perspective of application functionality.

Leonardo et al. [21] conducted extensive research and pointed out that some attributes representing widgets play a negative role and how designing the semantic matching process is the most influential component to matched results. Their key findings point to an entry point for better reuse of test. Up to now, there is still no effective method to solve semantic problems [25, 26]. Trying to optimize the generated test sequence to ensure the quality of reused tests should be an optional strategy.

III. OUR APPROACH

Figure 2 shows an overview of the proposed test reuse approach TRASM. Based on semantic matching of events, TRASM considers the test (*source test*) of the existing application (*source app*), and the new application (*target app*) as inputs and outputs target test. TRASM employs two significant phases to implement test reuse: preliminary preparation and source test reuse. For the former, the existing data is processed through test augmentation and model extraction to facilitate the implementation of source test reuse. For the latter, the processed data obtained by the former is used together to reuse the source test on the target app.

Test augmentation and model extraction are preliminary preparation steps that follow existing work [19], and we will only briefly introduce them. In detail, we focus on introducing our main contributions.

A. Test augmentation

The main task of test augmentation is to extract semantic information of widgets during the execution of collected source tests. The semantically represented widgets, together with actions, compose augmented tests, which are used to match widgets in the GUI of the target app.

After the source app executes each event, the *adb* tool¹ is used to extract the semantic information of the corresponding widget in the executed event according to the reached GUI state. Multiple attributes (including class, resource-id, text, content-desc, clickable, password, parent_text, sibling_text, activity, and package) uniquely represent a widget in the GUI. These non-empty attributes and their values constitute the widget's semantic information. For example, for widget w_1^t of test (a) in Figure 1, the collected semantic information is shown in Table 1.

¹<https://developer.android.com/studio/command-line/adb.html>

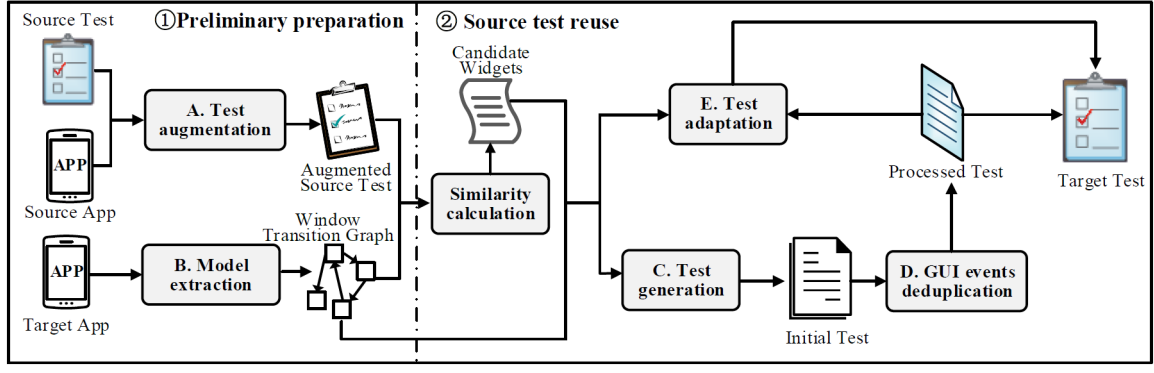

Figure 2. The overview of TRASM.

Table 1. The semantic information of widget w_1^t .

Attribute	Value
class	android.widget.ImageButton
resource-id	fab_new_task
clickable	true
password	false
activity	.view.MainActivity
package	org.secuso.privacyfriendlytodolist

B. Model extraction

The model extraction aims to statically analyze the source code obtained by the target app to obtain the window transition graph (WTG). Following with existing work, we employ tool² to obtain the WTG. And the steps of constructing WTG can refer to literature [19].

The WTG can visually represent the interaction between application activities and is composed of node sets and edges. Among WTG, the node represents the activity of the application, and the directed edge represents the activity transition that the event can trigger. For example, for the test (b) of application *Minimal* in Figure 1, the window transition triggered by the execution of the event is shown in Figure 3, where the nodes Main and AddToDo respectively represent the two activities of the application *Minimal*. By triggering the event on edge, state transition occurs between activities. The obtained WTG can provide matching candidate widgets for widgets in the source test. However, the WTG obtained may be incomplete. More fully, we adopt updating the WTG based on the feedback running information when executing the application.

C. Test generation

The purpose of test generation is to generate the initial test on the target app according to the semantic information of the augmented test and the WTG of the target app.

Every event in the augmented test iteratively matches the corresponding events in the target app. The candidate widgets are first obtained by similarity calculation to match the event.

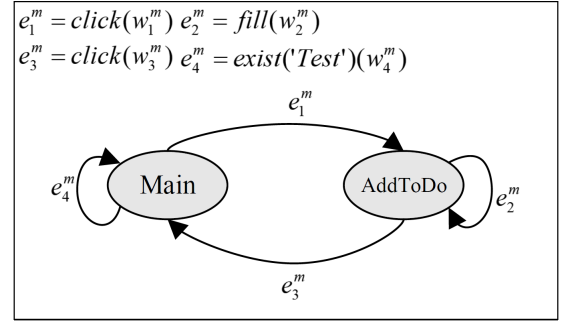

Figure 3. Window transition triggered by test (b).

Similarity calculation. For each widget, the semantic information is captured from the current GUI page of the target app to build a word list of attributes. For example, the attribute ‘resource-id’ of widget w_1^t and widget w_2^m are ‘et_new_task_name’ and ‘userToDoEditText’ respectively. After preprocessing [10, 19], we get two word lists $a=[\text{‘edit’}, \text{‘text’}, \text{‘new’}, \text{‘task’}, \text{‘name’}]$ and $a'=[\text{‘user’}, \text{‘todo’}, \text{‘edit’}, \text{‘text’}]$. For any word $w \in a$ and $w' \in a'$, the highest similarity $\max sim(w, w')$ between words w and w' is synthesized as the similarity of attributes:

$$sim(a, a') = \frac{\sum_{w \in a} \max_{w' \in a'} sim(w, w')}{|a|} \quad (1)$$

where a and a' represent the attributes corresponding to widget S in source test and widget T in target app respectively, $sim(w, w')$ expresses the cosine distance of the word vectors \vec{V}_w and $\vec{V}_{w'}$, obtained by the Word2Vec model[27]:

$$sim(w, w') = \frac{\vec{V}_w \cdot \vec{V}_{w'}}{|\vec{V}_w| |\vec{V}_{w'}|} \quad (2)$$

Based on Equation (1), we get the similarity between widget S and widget T :

$$sim(S, T) = \frac{\sum_{a \in S} sim(a, a') * wg(a)}{|S|} \quad (3)$$

where, $wg(a)$ represents the weight of attribute a among all attributes. Based above calculation, we build candidate

²<https://drive.google.com/file/d/1HEFS96c5nNKnzBPKwIRdwBiunOHgOs-/view?usp=sharing>

widgets by selecting several widgets in the target app with high similarity.

We identify a reachable widget based on the obtained candidate widgets and assign an action to form an event. All the paths from the current activity to the activity of each candidate widget can be queried from the WTG. These paths are executed to identify the reachable widget and return leading events. In addition, to avoid repeated path exploration, we adopt a strategy to preserve the path that has been explored and the corresponding leading events. For example, when matching event e_2^t in test (a), the application *Minimal* reaches the AddToDo activity after executing event e_1^m as shown in Figure 3, and then candidate widgets on the current page are collected. From the stored explored paths, it is found that there is a reachable path between activity AddToDo and activity AddToDo. Widget w_2^m is located in the reachable path, which is identified as a reachable widget. Finally, according to the source event, the action is allocated to the widget w_2^m .

D. GUI events deduplication

Invalid repeated events will increase the complexity of test execution. Although repeated events in the test will not affect the triggering of the behavior of an application, GUI events deduplication intends to reduce the time consumption occupied by such events.

Since the GUIs of the two applications are different, the target app may not have the special functionality contained in the source test. As explained in Section I, the reuse of special functionality in test (a), that is, the matching of event e_0^t on application *Minimal*, is meaningless. To remove such GUI events in the test sequence, deduplication is performed. However, it is a challenge to identify the meaningless events in the test. We take the operation of detecting and deleting duplicate events unrelated to the generated initial test. Considering the variety of possible duplicate event patterns, we set two rules to distinguish them. First, if only a single event is repeated in the initial test, we delete the repeated events at the beginning of the test sequence. Second, if the test sequence starts with $\langle e_{n_0}, e_{n_1} \rangle$ and also contains $\langle e_{n_1}, e_{n_0} \rangle$ such events, we delete the pair of events. After this operation, to maintain the correctness, we check whether the test after deduplication, that is, the processed test, can maintain the functionality as the initial test. If not, we will give up the GUI events deduplication.

E. Test adaptation

The goal of test adaptation is to explore whether there is a better test sequence than the processed test using the designed adaptation strategy.

Test generation always prioritizes the widget with the highest similarity for matching. When the method of calculating similarity does not work well, it may not be possible to distinguish the best widgets to match, which will affect the accuracy of the result. The design idea of test adaptation is to find indexes that may have more semantically similar events in the processed test and then rematch them. However,

determining such indexes in the sequences of the processed test is a challenging task. In this paper, we first record the indexes for which widgets in the processed test have higher similarity to another widget in the augmented test, except for the current matching event. Then, we choose the indexes with the lowest similarity of matching events in the processed test, which tries to mine the event with the incorrect match. After these two processing stages, we obtain the index sets of events that can perform rematching. Based on the above, we successively rematch the events of each index set from the candidate widgets obtained by Section III-C. We set the early termination condition to obtain a new test sequence that is more semantically similar than the original ones.

We explain how test adaptation solves the problem of reusing test (b) to application *To-Do List* in Figure 1. As mentioned in Section I, different GUI designs make the similarity between the correct widget and the source widget low, resulting in the incorrect match of event e_3^m . Through the strategies mentioned above, we get the index of event e_3^m to be rematched. Then, combined with the WTG obtained from the model extraction, the correct reachable widget w_3^t is searched again from the obtained candidate widgets on this index to form event e_3^t . Finally, the process ends after the oracle event e_4^t matching.

IV. EXPERIMENTAL EVALUATION

We implement our approach TRASM as a tool. Moreover, we compared TRASM with the baseline approach CRAFT-DROID [19], a test transfer method across mobile applications through semantic mapping, to verify the effectiveness and efficiency of TRASM. In this section, we introduce the experimental setup and experimental results to evaluate TRASM.

A. Experimental setup

For consistency, we reused the dataset³ of [19] to evaluate the proposed TRASM. Following the steps of the baseline, we conducted reuse tests on 15 applications in three categories, including *browser*, *Tip Calculator*, and *To-Do List*. These applications come from Google Play and F-Droid, which are often used in the GUI testing field to explore the functionalities of application [5, 24, 25]. Concretely, Table 2 details the category, name (version), and source of each application.

Specifically, for each application category, two typical functionalities are selected, and the corresponding tests of each application are collected according to the functionalities. To achieve the goal of verifying the implemented functionality, the last event of each test case is set as an oracle. In general, there are six functionalities in three categories of applications, as shown in Table 3. Table 3 lists the number of test cases for each functionality and the average number of GUI and oracle events.

Our experiment was implemented on a Nexus 5X Emulator running Android 6.0 (API 23) installed on a Ubuntu desktop with a 3.4 GHz Intel Core i7 CPU and 32 GB RAM.

³<https://sites.google.com/view/craftdroid/>

Table 2. The specific information of applications.

Category	Application (version)	Source
a1-Browser	a11-Lightning (4.5.1)	F-Droid
	a12-Browser for Android (6.0)	Google Play
	a13-Privacy Browser (2.10)	F-Droid
	a14-FOSS Browser (5.8)	F-Droid
	a15-Firefox Focus (6.0)	Google Play
a2-Tip Calculator	a21-Tip Calculator (1.1)	Google Play
	a22-Tip Calc (1.11)	Google Play
	a23-Simple Tip Calculator (1.2)	Google Play
	a24-Tip Calculator Plus (2.0)	Google Play
	a25-Free Tip Calculator (1.0.0.9)	Google Play
a3-To Do List	a31-Minimal (1.2)	F-Droid
	a32-Clear List (1.5.6)	F-Droid
	a33-To-Do List (2.1)	F-Droid
	a34-Simply Do (0.9.1)	F-Droid
	a35-Shopping List (0.10.1)	F-Droid

Table 3. Tests for the typical functionalities.

Functionality	Test Cases	Avg GUIs	Avg Oracles
b11-Access website by URL	5	3.4	1
b12-Back button	5	7.4	3
b21-Calculate total bill with tip	5	3.8	1
b22-Split bill	5	4.8	1
b31-Add task	5	4	1
b32-Remove task	5	6.8	2
Total	30	5.1	1.5

B. Experimental results

This subsection presents the experimental results of TRASM and the baseline approach CRAFTDROID under the same evaluation metrics. For each functionality of each category, we reuse the test of one application on the remaining four applications respectively, and the total number of test reuse is $5(\text{test cases}) \times 4(\text{target applications}) = 20$. This paper shows the average result of 20 different test reuses. In order to avoid randomness, for each test reuse, we take the average of the multiple results recorded.

Effectiveness. By comparison, the tests reused by TRASM perform higher usability than CRAFTDROID. The following two aspects, including the evaluation of successful reuse and the evaluation of matching events, can support the usability of the TRASM approach reuse test.

Regarding reuse success rate, TRASM has significantly improved test reuse in 3 of the six functionalities, as shown in the last column of Table 4. For functionalities b21 and b22, successfully reused tests achieved a 10% increase. For functionality b32, successful reuse also increased from 20% to 25%. In addition, 2 of the six functionalities, namely b11 and b12, have shown the highest successful reuse, i.e., 100%, no matter whether it is approach CRAFTDROID or TRASM.

For the evaluation of matching events, the third and fourth columns of Table 4 list the precision and recall of GUI events and oracle events, respectively. As shown in the table, compared with CRAFTDROID, TRASM improves the precision of the GUI by 5% to 15% in different functionalities. Unfortunately, while improving the precision, the recall rate of GUI events for functionalities b22 and b32 has decreased slightly by 2% and 3%, respectively. The success of the reused test depends on whether the match of the last oracle event

in the test sequence is correct. Therefore, the improvement of successful reuse also represents the increase in the recall rate of oracle events, as listed in Table 4. Among them, the most significant is that for functionalities b21 and b22, the recall rate is improved by 10%. In general, the improvement in the precision and the recall of oracle events shows that the proposed TRASM indeed increases the availability of the reused test.

Efficiency. Figure 4 lists the average test reuse time on each functionality. It is obvious that the average time spent on reuse testing of TRASM is less than that of CRAFTDROID for each functionality. Even the most significant effect is that for functionality b21, the average reuse test of CRAFTDROID takes 2581 seconds (43 minutes), while our TRASM only takes 890 seconds (15 minutes), which is close to 35% of the time of CRAFTDROID. In summary, the results are attributed to two factors. One is that the storage of explored paths avoids repeated time consumption, and the other is that the adaptive strategy improves the efficiency of widget matching. The above results prove that we can break through the limitation on efficiency in CRAFTDROID.

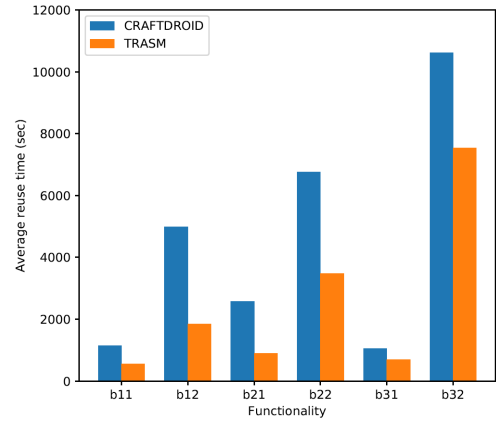

Figure 4. The average test reuse time on each functionality.

While evaluating the efficiency of TRASM, an important finding is that implementing an adaptive strategy can improve the success of some reused tests. Inevitably, the potential drawback is that more suitable event matching can not be found will bring additional time consumption. We need to address this crucial point further to balance efficiency and effectiveness.

V. CONCLUSION

Test reuse as an alternative method of test generation can help developers verify the behavior of applications. In this paper, a novel test reuse approach has been proposed to alleviate the challenge of semantic problems in event matching. From the initial test set, we have extended GUI events deduplication and test adaptation to build up target tests. The experimental results indicate that our proposed approach achieves better performance than the baseline approaches with increased usability of the reused tests.

Table 4. Effectiveness and Efficiency Evaluation

Functionality	Approach	GUI Event		Oracle Event		Successful Reuse
		Precision	Recall	Precision	Recall	
b11	CRAFTDROID	79%	100%	100%	100%	20/20(100%)
	TRASM	100%	100%	100%	100%	20/20(100%)
b12	CRAFTDROID	85%	100%	100%	100%	20/20(100%)
	TRASM	100%	100%	100%	100%	20/20(100%)
b21	CRAFTDROID	82%	100%	100%	80%	16/20(80%)
	TRASM	93%	100%	100%	90%	18/20(90%)
b22	CRAFTDROID	80%	100%	100%	65%	13/20(65%)
	TRASM	85%	98%	100%	75%	15/20(75%)
b31	CRAFTDROID	78%	100%	85%	100%	17/20(85%)
	TRASM	87%	100%	85%	100%	17/20(85%)
b32	CRAFTDROID	69%	100%	85%	80%	11/20(55%)
	TRASM	81%	97%	93%	81%	12/20(60%)

We believe that matching events are a promising direction, and we plan to study how to improve the matching strategy further in the future. In addition, we plan to verify the generalization of the method and further explore the effect of test reuse on more applications.

ACKNOWLEDGMENTS

The work is partially supported by the National Natural Science Foundation of China (No. 61972197), the Natural Science Foundation of Jiangsu Province (No. BK20201292), and the Collaborative Innovation Center of Novel Software Technology and Industrialization. T. Chen is partially supported by an oversea grant from the State Key Laboratory of Novel Software Technology, Nanjing University (KFKT2022A03), Birkbeck BEI School Project (EFFECT), National Natural Science Foundation of China (NSFC) under Grants (No. 62072309, 62272397).

REFERENCES

- [1] S. Anand, M. Naik, M. J. Harrold, and H. Yang, “Automated concolic testing of smartphone apps,” *Proceedings of the ACM SIGSOFT 20th International Symposium on the Foundations of Software Engineering*, pp. 1–11, November 2012.
- [2] M. E. Joorabchi, A. Mesbah, and P. Kruchten, “Real challenges in mobile app development,” *2013 ACM/IEEE International Symposium on Empirical Software Engineering and Measurement*. IEEE, pp. 15–24, October 2013.
- [3] P. S. Kochhar, F. Thung, N. Nagappan, T. Zimmermann, and D. Lo, “Understanding the test automation culture of app developers,” *2015 IEEE 8th International Conference on Software Testing, Verification and Validation*. IEEE, pp. 1–10, April 2015.
- [4] M. Linares-Vásquez, C. Bernal-Cárdenas, K. Moran, and D. Poshyanyk, “How do developers test android applications?” in *2017 IEEE International Conference on Software Maintenance and Evolution (ICSME)*. IEEE, pp. 613–622, September 2017.
- [5] K. Mao, M. Harman, and Y. Jia, “Sapienz: Multi-objective automated testing for android applications,” *Proceedings of the 25th international symposium on software testing and analysis*, pp. 94–105, July 2016.
- [6] A. Machiry, R. Tahiliani, and M. Naik, “Dynodroid: An input generation system for android apps,” *Proceedings of the 2013 9th Joint Meeting on Foundations of Software Engineering*, pp. 224–234, August 2013.
- [7] T. X. Gu, C. N. Sun, X. X. Ma, C. Cao, C. Xu, Y. Yao, Q. R. Zhang, J. Lu, and Z. D. Su, “Practical gui testing of android applications via model abstraction and refinement,” *2019 IEEE/ACM 41st International Conference on Software Engineering*. IEEE Computer Society, pp. 269–280, August 2019.
- [8] N. Mirzaei, H. Bagheri, R. Mahmood, and S. Malek, “Sig-droid: Automated system input generation for android applications,” *2015 IEEE 26th International Symposium on Software Reliability Engineering*. IEEE Computer Society, pp. 461–471, November 2015.
- [9] M. Ermuth and M. Pradel, “Monkey see, monkey do: Effective generation of gui tests with inferred macro events,” *Proceedings of the 25th International Symposium on Software Testing and Analysis*, pp. 82–93, July 2016.
- [10] Y. Zhou, Y. Su, T. Chen, Z. Huang, H. C. Gall, and S. Panichella, “User review-based change file localization for mobile applications,” *IEEE Transactions on Software Engineering*, vol. 47, no. 12, pp. 2755–2770, January 2020.
- [11] Z. Dong, M. Böhme, L. Cojocar, and A. Roychoudhury, “Time-travel testing of android apps,” *2020 IEEE/ACM 42nd International Conference on Software Engineering*, Seoul, South Korea, pp. 481–492, July 2020.
- [12] A. Memon, I. Banerjee, and A. Nagarajan, “Gui ripping: Reverse engineering of graphical user interfaces for testing,” *10th Working Conference on Reverse Engineering, 2003. WCRE 2003. Proceedings*. Citeseer, pp. 260–269, 2003.
- [13] T. Su, G. Meng, Y. Chen, K. Wu, W. Yang, Y. Yao, G. Pu, Y. Liu, and Z. Su, “Guided, stochastic model-based gui testing of android apps,” *Proceedings of the 2017 11th Joint Meeting on Foundations of Software Engineering*, pp. 245–256, August 2017.
- [14] D. Amalfitano, A. R. Fasolino, P. Tramontana, S. De Carmine, and A. M. Memon, “Using gui ripping for automated testing of android applications,” *2012 Proceedings of the 27th IEEE/ACM International Conference on*

- Automated Software Engineering*. IEEE, pp. 258–261, September 2012.
- [15] J. Wang, Y. Y. Jiang, C. Xu, C. Cao, X. X. Ma, and J. Lu, “Combodroid: generating high-quality test inputs for android apps via use case combinations,” *Proceedings of the ACM/IEEE 42nd International Conference on Software Engineering*, pp. 469–480, June 2020.
 - [16] F. Behrang and A. Orso, “Automated test migration for mobile apps,” *Proceedings of the 40th International Conference on Software Engineering: Companion Proceedings*, pp. 384–385, May 2018.
 - [17] F. Behrang and A. Orso, “Test migration between mobile apps with similar functionality,” *2019 34th IEEE/ACM International Conference on Automated Software Engineering*. IEEE Computer Society, pp. 54–65, November 2019.
 - [18] F. Behrang and A. Orso, “Apptestmigrator: a tool for automated test migration for android apps,” *2020 IEEE/ACM 42nd International Conference on Software Engineering: Companion Proceedings*. IEEE, pp. 17–20, October 2020.
 - [19] J. W. Lin, R. Jabbarvand, and S. Malek, “Test transfer across mobile apps through semantic mapping,” *2019 34th IEEE/ACM International Conference on Automated Software Engineering*, pp. 42–53, November 2019.
 - [20] Q. Mao, W. W. Wang, F. You, R. L. Zhao, and Z. Li, “User behavior pattern mining and reuse across similar android apps,” *Journal of Systems and Software*, vol. 183, pp. 111085, September 2021.
 - [21] L. Mariani, A. Mohebbi, M. Pezzè, and V. Terragni, “Semantic matching of gui events for test reuse: are we there yet?” *Proceedings of the 30th ACM SIGSOFT International Symposium on Software Testing and Analysis*, pp. 177–190, July 2021.
 - [22] X. Qin, H. Zhong, and X. Y. Wang, “Testmig: Migrating gui test cases from ios to android,” *Proceedings of the 28th ACM SIGSOFT International Symposium on Software Testing and Analysis*, pp. 284–295, July 2019.
 - [23] A. Rau, J. Hotzkow, and A. Zeller, “Poster: Efficient gui test generation by learning from tests of other apps,” *2018 IEEE/ACM 40th International Conference on Software Engineering: Companion (ICSE-Companion)*. IEEE, pp. 370–371, June 2018.
 - [24] A. Rau, J. Hotzkow, and A. Zeller, “Transferring tests across web applications,” *International Conference on Web Engineering*. Springer, pp. 50–64, May 2018.
 - [25] S. R. Choudhary, A. Gorla, and A. Orso, “Automated test input generation for android: Are we there yet?(e),” *2015 30th IEEE/ACM International Conference on Automated Software Engineering*. IEEE, pp. 429–440, November 2015.
 - [26] X. Zeng, D. Li, W. Zheng, F. Xia, Y. Deng, W. Lam, W. Yang, and T. Xie, “Automated test input generation for android: Are we really there yet in an industrial case?” in *Proceedings of the 2016 24th ACM SIGSOFT International Symposium on Foundations of Software Engineering*, pp. 987–992, November 2016.
 - [27] T. Mikolov, I. Sutskever, K. Chen, G. S. Corrado, and J. Dean, “Distributed representations of words and phrases and their compositionality,” *Advances in neural information processing systems*, vol. 26, 2013.