

# EFFECTIVE METHOD OF COMPUTING LI'S COEFFICIENTS AND THEIR PROPERTIES

KRZYSZTOF MAŚLANKA

ABSTRACT. In this paper we present an effective method for computing certain real coefficients  $\lambda_n$  which appear in a criterion for the Riemann hypothesis proved by Xian-Jin Li. With the use of this method a sequence of two-thousand  $\lambda_n$ 's has been calculated. This sequence reveals a peculiar and unexpected behavior: it can be split into a strictly growing *trend* and some tiny *oscillations* superimposed on this trend.

## 1. INTRODUCTION

Since its formulation almost a century and a half ago the Riemann hypothesis (hereafter called RH) is commonly regarded as both the most challenging and the most difficult task in number theory [8]. It states that all complex zeroes of the zeta function, defined by the following series if  $\Re s > 1$

$$(1.1) \quad \zeta(s) = \sum_{n=1}^{\infty} \frac{1}{n^s}$$

and by analytic continuation to the whole plane, are located right on the critical line  $\Re s = \frac{1}{2}$ . RH, if true, would shed more light on our knowledge of the distribution of prime numbers. More precisely, the absence of zeroes of  $\zeta(s)$  in the half-plane  $\Re s > \theta$  implies that (see [5], theorem 30)

$$(1.2) \quad \pi(x) = \text{li}(x) + O(x^\theta \log x)$$

where  $\pi(x)$  is the number of primes not exceeding  $x$  and  $\text{li}(x)$  denotes logarithmic integral. Therefore, the value  $\theta = \frac{1}{2}$  (as Riemann conjectured) makes the theorem useful since the error term in (1.2) is the smallest possible. We do know that on the critical line lie infinitely many complex zeroes [4] and that among several billions of initial zeroes there is no counterexample to RH [9]. Nevertheless, so far nobody could either prove or disprove in a rigorous way that this would be the case all the way out to infinity (see Fig. 1).

(Place Figure 1 about here.)

---

*Date:* 9 February 2004.

*Key words and phrases.* Riemann zeta function, Riemann hypothesis, Li's criterion, numerical methods in analytic number theory.

e-mail: maslanka@oa.uj.edu.pl.

## 2. LI'S CRITERION

In 1997 Xian-Jin Li [6] presented an interesting criterion equivalent to the Riemann hypothesis:

**Theorem 2.1.** *RH is true if and only if all coefficients*

$$(2.1) \quad \lambda_n := \frac{1}{\Gamma(n)} \frac{d^n}{ds^n} \left[ s^{n-1} \ln \xi(s) \right] \Big|_{s=1}$$

are non-negative, where

$$(2.2) \quad \xi(s) = 2(s-1) \pi^{-s/2} \Gamma\left(1 + \frac{s}{2}\right) \zeta(s).$$

An equivalent definition of  $\lambda_n$  is (see [6], formula 1.4):

$$(2.3) \quad \lambda_n = \sum_{\rho} \left( 1 - \left( 1 - \frac{1}{\rho} \right)^n \right)$$

where the sum runs over all (paired) complex zeroes of the Riemann zeta-function. However, the above definitions of  $\lambda_n$  are not suitable for numerical calculations. In this paper I shall present an effective method for calculating these coefficients. The gathered data investigated numerically up to  $n = 2000$  reveals unexpected properties: it contains a strictly growing trend plus extremely small oscillations superimposed on this trend.

The following decomposition of  $\lambda_n$  is implicitly given in a recent paper by Bombieri and Lagarias ([1], Theorem 2):

$$(2.4) \quad \lambda_n = \underbrace{1 - (\log(4\pi) + \gamma) \frac{n}{2} + \sum_{j=2}^n (-1)^j \binom{n}{j} (1 - 2^{-j}) \zeta(j)}_{\text{trend}} - \underbrace{\sum_{j=1}^n \binom{n}{j} \eta_{j-1}}_{\text{oscillations}} \equiv \bar{\lambda}_n + \tilde{\lambda}_n$$

Using the language of signal theory (perhaps not very common but sometimes appropriate in number theory) one can say that the decomposition (2.4) uniquely “splits” the behavior of the sequence of  $\{\lambda_n\}$  into a strictly growing *trend*  $\bar{\lambda}_n$  and certain tiny *oscillations*  $\tilde{\lambda}_n$  superimposed on it. It may be proved that the trend is indeed strictly growing as  $n$  tends to infinity. The trend may be expressed as

$$(2.5) \quad \bar{\lambda}_n = \frac{1}{\Gamma(n)} \frac{d^n}{ds^n} \left[ s^{n-1} \ln \left( \pi^{-s/2} \Gamma\left(1 + \frac{s}{2}\right) \right) \right] \Big|_{s=1}$$

It is evident that (2.5) differs from the main definition (2.1) simply by replacing  $\xi(s)$  by the much simpler function  $\pi^{-s/2}\Gamma(1+s/2)$ . I shall return to this decomposition later.

The starting point of Li's approach to RH is a certain transformation of the complex plane into itself using the map  $s \mapsto 1 - 1/s$  (which is a special case of Möbius transformation). Under this transformation the half-plane  $\Re s > \frac{1}{2}$  is mapped into the unit disk (with the critical line  $\Re s = \frac{1}{2}$  becoming the unit circle, see Figs. 2 and 3). This was Li's original idea. However, he was inspired by studying A. Weil's proof of RH for function fields over finite fields where the critical line is transformed into a unit circle [7].

(Place Figures 2 and 3 about here.)

### 3. THE MAIN DERIVATION

It has been known since medieval times that the harmonic series  $\sum_{k=1}^{\infty} 1/k$  diverges. This was proved long ago with the use of elementary methods by Nicole d'Oresme in the 14th century, and, much later, independently by Pietro Mengoli (in his book on arithmetic series *Novae quadraturae arithmeticae*, 1650) as well as, using yet another method, by the Bernoulli brothers.

A natural question emerges: how fast does this series diverge? It turns out that its divergence is "weak", more precisely: logarithmic. The quantitative answer to this question implies the definition of the following famous number called the Euler-Mascheroni constant:

$$(3.1) \quad \gamma := \lim_{x \rightarrow \infty} \left( \sum_{k \leq x} \frac{1}{k} - \log x \right) = 0,5772156649\dots$$

Its natural generalization is the sequence  $\gamma_n$  defined by

$$(3.2) \quad \gamma_n = \frac{(-1)^n}{n!} \lim_{x \rightarrow \infty} \left( \sum_{k \leq x} \frac{1}{k} (\log k)^n - \frac{(\log x)^{n+1}}{n+1} \right)$$

where  $\gamma_0 = \gamma$ . These are the so-called Stieltjes constants. Another "similar" very useful sequence denoted by  $\eta_n$  is defined by

$$(3.3) \quad \eta_n := \frac{(-1)^n}{n!} \lim_{x \rightarrow \infty} \left( \sum_{k \leq x} \frac{\Lambda(k)}{k} (\log k)^n - \frac{(\log x)^{n+1}}{n+1} \right),$$

where  $\Lambda(k)$  is the so-called von Mangoldt function defined for any positive integer  $k$  as:

$$(3.4) \quad \Lambda(k) = \begin{cases} \log p & \text{if } k \text{ is a prime } p \text{ or any power of a prime } p^n \\ 0 & \text{otherwise} \end{cases}$$

The above sequences are important on their own right since they appear in the Laurent expansions for  $\zeta(s)$  and its logarithmic derivative around

$s = 1$ . (There are different conventions when defining these numbers, here I have adopted those of Bombieri and Lagarias [1]):

$$(3.5) \quad \begin{aligned} \zeta(s+1) &= \frac{1}{s} + \sum_{n=0}^{\infty} \gamma_n s^n \\ -\frac{\zeta'}{\zeta}(s+1) &= \frac{1}{s} + \sum_{n=0}^{\infty} \eta_n s^n \end{aligned}$$

It should also be noted that the function **StieltjesGamma[n]** implemented in Wolfram's *Mathematica*, which employs Keiper's algorithm, uses a different convention.

Integrating the second equation (3.5) with respect to  $s$ , inserting the result into the first one and equating coefficients in the appropriate powers of the variable  $s$  one can find explicit relations between the  $\gamma_n$  and the  $\eta_n$ :

$$(3.6) \quad \begin{aligned} \sum_{n=0}^{\infty} \eta_n \frac{s^{n+1}}{n+1} &= -\log \left( 1 + \sum_{n=0}^{\infty} \gamma_n s^{n+1} \right) \\ \sum_{n=0}^{\infty} \eta_n \frac{s^{n+1}}{n+1} &= \sum_{k=1}^{\infty} \frac{(-1)^k}{k} s^k \underbrace{\left( \sum_{n=0}^{\infty} \gamma_n s^n \right)^k}_{\sum_{n=0}^{\infty} c_n^{(k)} s^n} \end{aligned}$$

Employing a certain formula from [3] (formula 0.314, i.e., raising a power series to an arbitrary integral exponent) one can express the  $c$  coefficients by the following recurrence relations:

$$(3.7) \quad \begin{aligned} c_0^{(k)} &= \gamma^k \\ c_m^{(k)} &= \frac{1}{m\gamma} \sum_{i=0}^{m-1} [km - (k+1)i] \gamma_{m-i} c_i^{(k)} \end{aligned}$$

The matrix of coefficients  $c$  depends on  $\{\gamma_n\}$ :

$$(3.8) \quad \begin{array}{cccccc} & m=0 & m=1 & m=2 & m=3 & m=4 \\ \begin{array}{l} k=1 \\ k=2 \\ k=3 \\ k=4 \\ k=5 \end{array} & \begin{array}{l} \gamma_0 \\ \gamma_0^2 \\ \gamma_0^3 \\ \gamma_0^4 \\ \gamma_0^5 \end{array} & \begin{array}{l} \gamma_1 \\ 2\gamma_0\gamma_1 \\ 3\gamma_0^2\gamma_1 \\ 4\gamma_0^3\gamma_1 \\ \dots \end{array} & \begin{array}{l} \gamma_2 \\ \gamma_1^2 + 2\gamma_0\gamma_2 \\ 3\gamma_0\gamma_1^2 + 3\gamma_0^2\gamma_2 \\ \dots \\ \dots \end{array} & \begin{array}{l} \gamma_3 \\ 2\gamma_1\gamma_2 + 2\gamma_0\gamma_3 \\ \dots \\ \dots \\ \dots \end{array} & \begin{array}{l} \gamma_4 \\ \dots \\ \dots \\ \dots \\ \dots \end{array} \end{array}$$

(In what follows only the upper triangular part of this infinite matrix will be needed.)

(Place Figure 4 about here.)

With the help of (3.6) the coefficients  $\eta_n$  may further be expressed using the elements of the matrix  $c$  as

$$(3.9) \quad \eta_n = (n+1) \sum_{k=0}^n \frac{(-1)^{k+1}}{k+1} c_{n-k}^{(k+1)}$$

From this we have:

$$(3.10) \quad \begin{aligned} \eta_0 &= -\gamma_0 \\ \eta_1 &= +\gamma_0^2 - 2\gamma_1 \\ \eta_2 &= -\gamma_0^3 + 3\gamma_0\gamma_1 - 3\gamma_2 \\ \eta_3 &= +\gamma_0^4 - 4\gamma_0^2\gamma_1 + 2\gamma_1^2 + 4\gamma_0\gamma_2 - 4\gamma_3 \\ \eta_4 &= -\gamma_0^5 + 5\gamma_0^3\gamma_1 - 5\gamma_0\gamma_1^2 - 5\gamma_0^2\gamma_2 + 5\gamma_1\gamma_2 + 5\gamma_0\gamma_3 - 5\gamma_4, \\ &\dots \end{aligned}$$

and finally the oscillating parts of  $\lambda$  as polynomials of Stieltjes gammas:

$$(3.11) \quad \tilde{\lambda}_n = - \sum_{j=1}^n \binom{n}{j} \eta_{j-1}.$$

Using now (3.10) and (3.11) we finally obtain:

$$(3.12) \quad \begin{aligned} \tilde{\lambda}_1 &= \gamma_0 \\ \tilde{\lambda}_2 &= 2\gamma_0 - \gamma_0^2 + 2\gamma_1 \\ \tilde{\lambda}_3 &= 3\gamma_0 - 3\gamma_0^2 + \gamma_0^3 + 6\gamma_1 - 3\gamma_0\gamma_1 + 3\gamma_2 \\ \tilde{\lambda}_4 &= 4\gamma_0 - 6\gamma_0^2 + 4\gamma_0^3 - \gamma_0^4 + 12\gamma_1 + 12\gamma_0\gamma_1 \\ &\quad + 4\gamma_0^2\gamma_1 - 2\gamma_1^2 + 12\gamma_2 - 4\gamma_0\gamma_2 + 4\gamma_3 \\ &\dots \end{aligned}$$

#### 4. APPLICATIONS AND CONCLUSIONS

Although the recurrent formulae (3.7) allow in principle to compute both  $\eta_n$  and  $\lambda_n$  with arbitrary accuracy for any value of  $n$ , it is clear that with increasing  $n$  the number of terms increases very rapidly<sup>1</sup>. It would be desirable to simplify the polynomials in (3.10) and (3.12), or at least to reveal some hidden regularities in them, but I doubt whether this is possible. The table below demonstrates that it would be even impractical to write down explicit expressions for, say,  $\lambda_n$  for  $n$  greater than 15 or 20.

---

<sup>1</sup>Using the On-Line Encyclopedia of Integer Sequences (<http://www.research.att.com/~njas/sequences/>) one can see that number of terms in  $\eta_n$  is equal to the number of partitions of  $n$  (partition number, **PartitionsP**[ $n$ ] in *Mathematica* notation), which grows like  $\exp(c\sqrt{n})$ , whereas the number of terms in  $\lambda_n$  is equal to the number of sums  $S$  of positive integers satisfying  $S \leq n$  (**Table[Sum[PartitionsP[k],{k,1,n}], {n, 1, 50}]** in *Mathematica* notation).

$n$	number of terms in $\eta_n$	number of terms in $\lambda_n$
0	1	-
1	2	1
2	3	3
3	5	6
4	7	11
5	11	18
10	56	138
20	792	2713
30	6842	28628
40	44583	215307
50	239943	1295970

Using the above formulae (3.7), (3.9) and (3.12) I have computed quite a lot of initial values of  $\{\eta_n\}$  and  $\{\lambda_n\}$ . First it was necessary to tabulate Stieltjes gammas with sufficient number of significant digits. The main calculations were rather time consuming and required also considerable amount of computer memory. For example, having 2000 pre-computed Stieltjes gammas, with 800 significant digits each, I calculated 2000 etas and almost 3300 lambdas. Due to finite accuracy and the obvious phenomenon of error accumulation, the number of significant digits in etas and lambdas decreases slowly with increasing  $n$  (see Fig. 5). Contrary to popular programming languages, *Mathematica* can handle arbitrary precision numbers, performs automatically full control of accuracy in numerical calculations, hence, what is crucial here, its final results are entirely reliable.

(Place Figure 5 about here.)

The main conclusion which stems from these calculations is contained in the following plots showing the trend of  $\lambda$  (Figure 6, upper plot) and the oscillating part of  $\lambda$  (lower plot). Their sum gives the coefficients which appear in Li's criterion for the RH. Note that the scales on both plots differ by nearly two orders of magnitude. As mentioned before, it is easy to show that the trend (2.5) is strictly growing. Therefore, if the oscillations were bounded or, at least, if their amplitude would grow with  $n$  slower than the trend, then RH would be true. In other words, we have a new RH criterion, which is simply a reformulation the original Li's result, but from the viewpoint of the present paper it has an obvious interpretation. It states that if for all positive integer  $n$

$$-\tilde{\lambda}_n \leq \bar{\lambda}_n$$

then RH is true. The numerical data gathered so far and presented in Fig. 6 is overwhelmingly in its favor. Of course, one should bear in mind that in number theory the numerical evidence, no matter how convincing,

may be just illusory. Nevertheless, it seems unlikely that the amplitude of oscillations would ever exceed the rapidly growing trend.

Finally I would like to stress out that so far there are no published extensive tables of Li's coefficients. All the numerical data obtained for preparation of this paper as well as appropriate *Mathematica* notebook is available from the author.

(Place Figure 6 about here.)

**Acknowledgments.** I would like to express my gratitude to Prof. Jeffrey C. Lagarias, AT&T Labs, for confirming the effect of tiny oscillations, as well as for several remarks concerning further development of the idea presented in this paper. I would also like to thank Dr. Mark W. Coffey, Department of Physics, Colorado School of Mines, for directing my attention to some misprints as well as for sending me a preliminary version of his paper prior to publication [2].

#### REFERENCES

- [1] Bombieri, E. and Lagarias, J. C., *Complements to Li's Criterion for the Riemann Hypothesis*, J. Number Theory **77**, 274-287 (1999)
- [2] Coffey, M., *Relations and positivity results for the derivatives of the Riemann  $\xi$  function*, J. Comp. Applied Math. **166**, 525-534 (2004)
- [3] Gradshteyn, I. S., Ryzhik, I. M., *Tables of Integrals, Series, and Products*, corr. enl. 4th ed. San Diego, CA: Academic Press, 1980
- [4] Hardy, G. H., *Sur le Zéros de la Fonction  $\zeta(s)$  de Riemann*, C. R. Acad. Sci. Paris, **158**, 1012-1014 (1914)
- [5] Ingham, A. E. *The distribution of prime numbers*, Cambridge University Press, 1932
- [6] Li, X.-J., *The Positivity of a Sequence of Numbers and the Riemann Hypothesis*, J. Number Theory **65**, 325-333 (1997)
- [7] Li, X.-J., private communication, 2003
- [8] Riemann, G. B. F., *Ueber die Anzahl der Primzahlen unter eine gegebenen Grösse*, Monatsberichte Königl. Preuss. Akad. Wiss. Berlin, 671 (1859)
- [9] Wedeniwski, S., *ZetaGrid - Verification of the Riemann Hypothesis*, available at <http://www.zetagrid.net>

#### Figure captions

- Figure 1. Distribution of zeroes of  $\zeta$  in the complex plane.
- Figure 2. Möbius transformation of the complex plane used by Li. The left fragment of the picture is just Fig. 1 reduced to its essential part: the critical strip. The half-plane  $\Re s > \frac{1}{2}$  (left picture) is mapped into the unit disk  $|z| < 1$  (right picture).
- Figure 3. Plot of  $1/|\zeta(z)|$  on a small part of the transformed complex plane containing all nontrivial zeroes. On the right fragment of Fig. 2 this part of complex plane is a small, very narrow rectangle near  $z = 1$ . Nontrivial zeroes are visible as sharp “pins”. White dots are added to help visualize that the zeroes indeed lie on a circle (which looks rather like an ellipse here since the scales on  $\Re z$  and  $\Im z$  are different).

The apparent lack of peaks in the center is an artifact. All complex zeroes are very crowded close to  $z = 1$  and the corresponding peaks are increasingly thinner. Obtaining a better picture would require a much higher density of points in which values of zeta are calculated (hence much more computer memory) and much higher resolution of the picture.

- Figure 4. Signs of the coefficients of matrix  $c$  (3.7) for  $k = 100$  with rows and columns labelled as in (3.8). Little white squares denote plus sign, black squares denote minus sign; grey squares mark unused entries of the matrix.
- Figure 5. Accuracies of various numbers used in this paper:  $\gamma_n$ ,  $\eta_n$  and  $\tilde{\lambda}_n$ . Having 2000 precomputed Stieltjes constants  $\gamma_n$ , with 800 significant digits each, I could (using Mathematica 5.0) obtain 2000 eta coefficients  $\eta_n$  and about 3300 oscillating parts of lambda  $\tilde{\lambda}_n$ , both with linearly decreasing accuracy. The accuracies of  $\eta_n$  and  $\tilde{\lambda}_n$  decrease due to complicated error cumulating but almost perfect linearity of their dependence is a priori not so obvious because the number of terms in (3.10) and (3.12) grows fast with increasing  $n$ . In particular, the fact that the accuracy of etas decreases *faster* than accuracy of lambdas is rather counter intuitive.
- Figure 6. The trend (upper plot) versus the oscillating part of  $\lambda$  (lower plot). Note different vertical scales. In fact, the sum of the trend and the oscillating part, i.e. full  $\lambda$ , would look exactly like the upper plot since the amplitude of the oscillations is smaller than the thickness of the graph line.



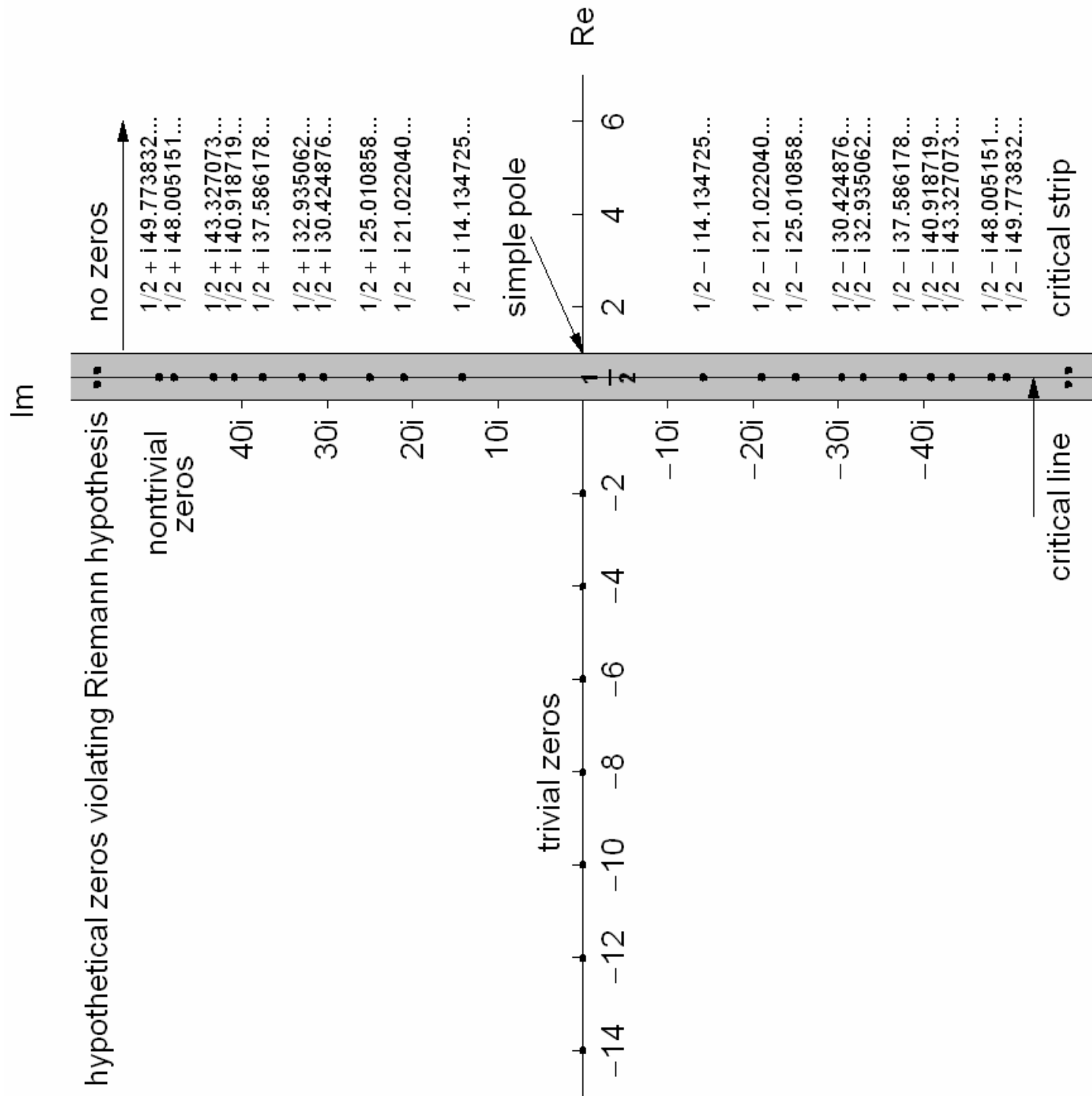

Figure 1.

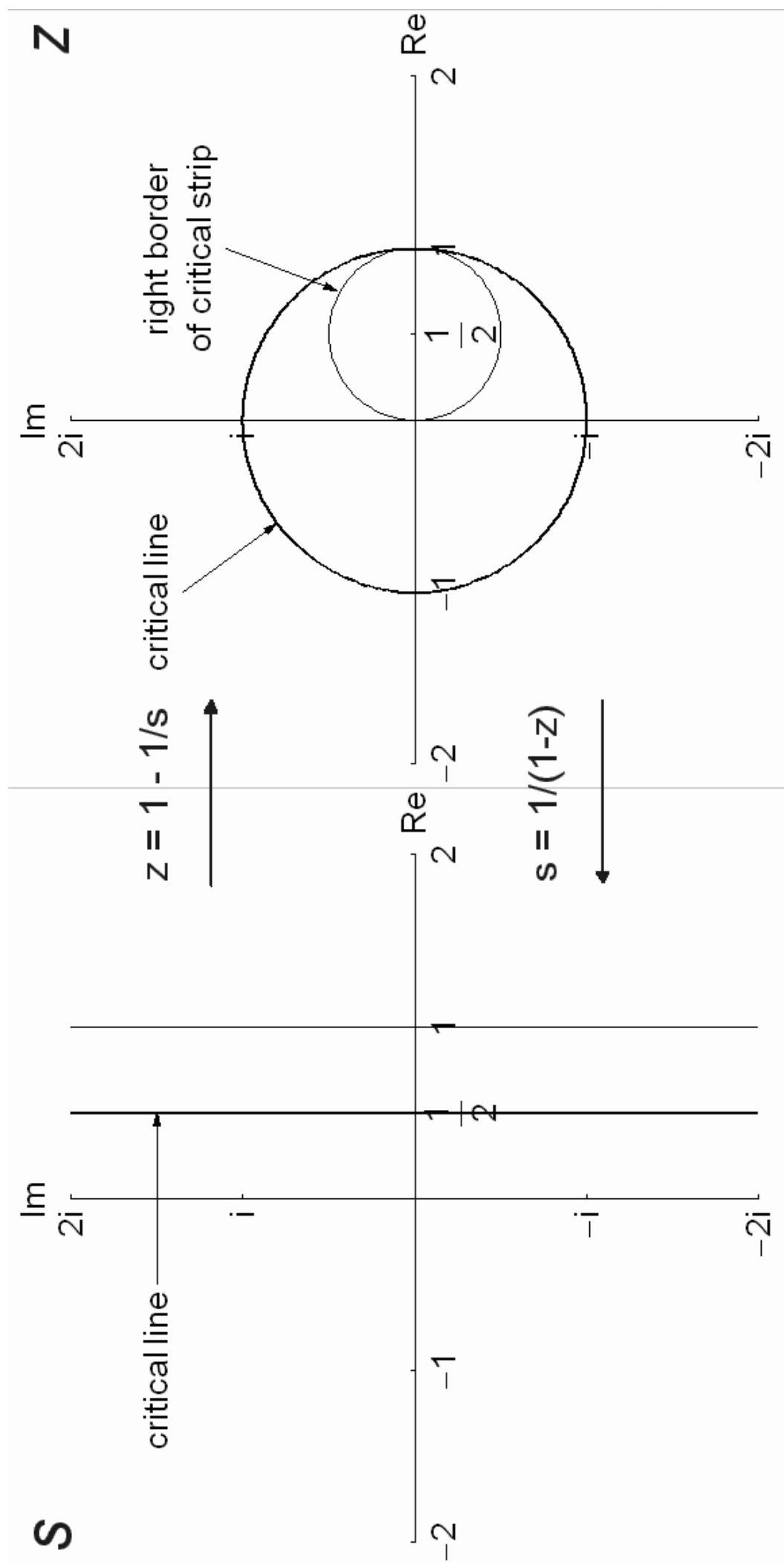

Figure 2

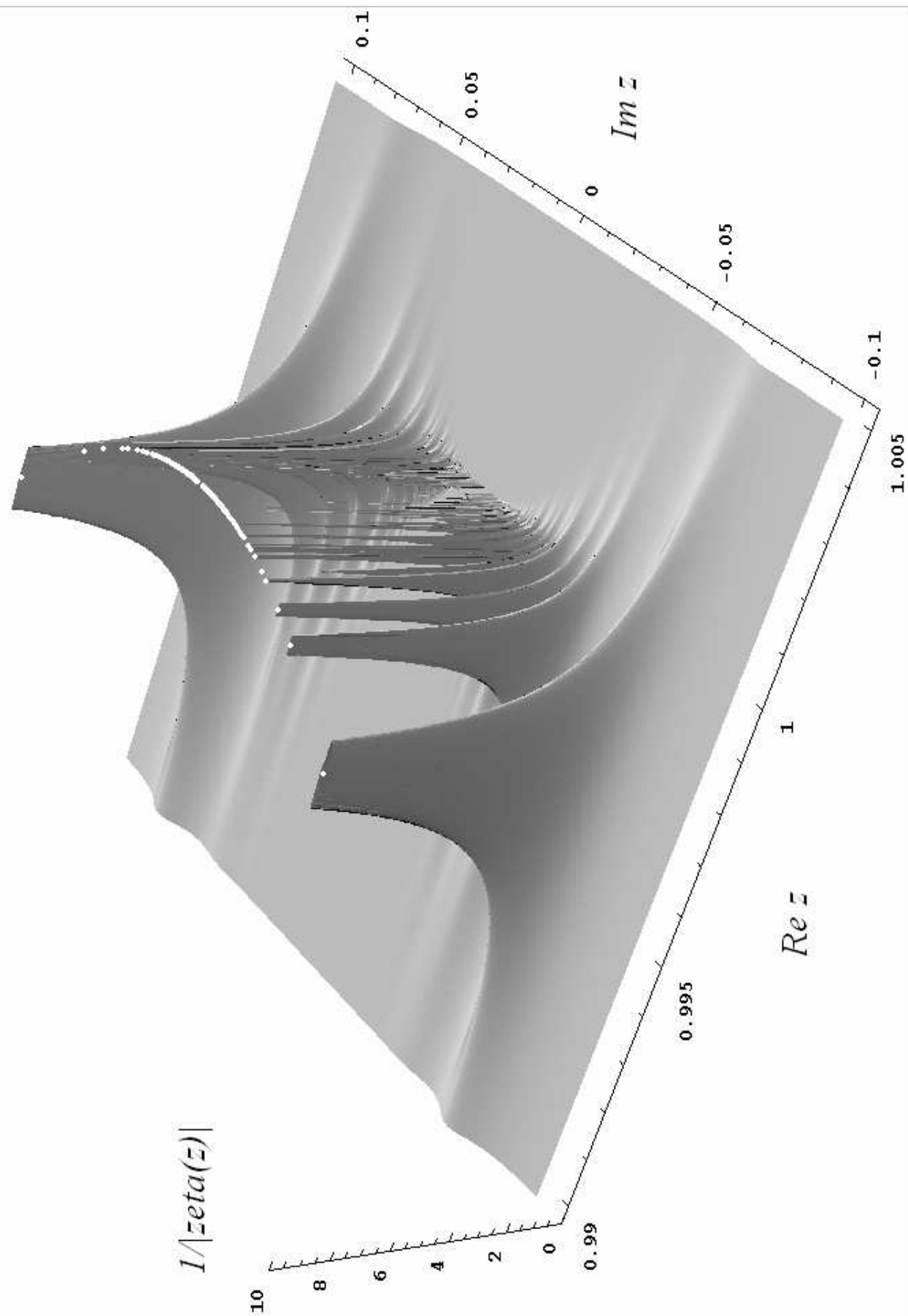

Figure 3.

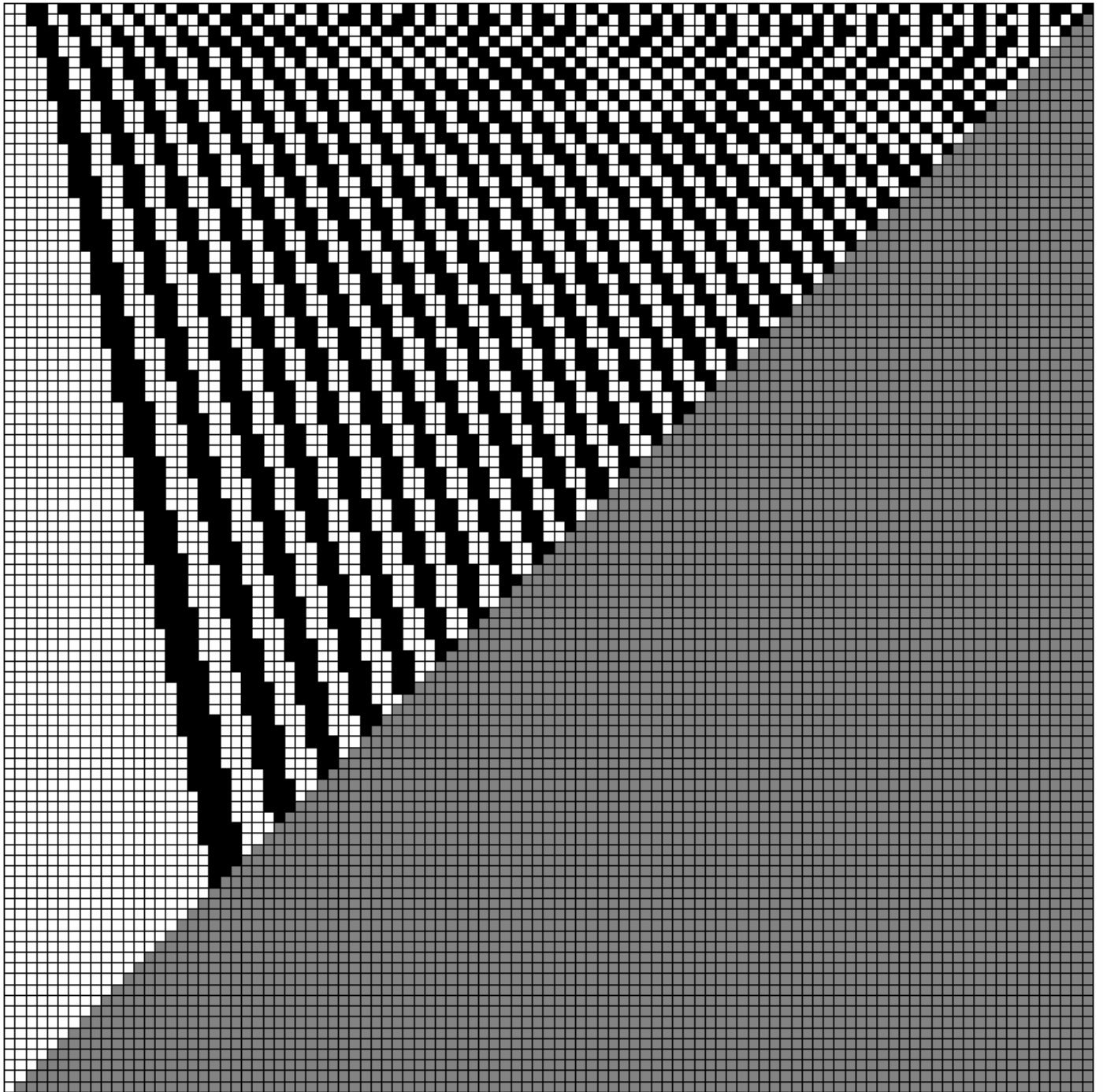

Figure 4.

## Number of significant digits

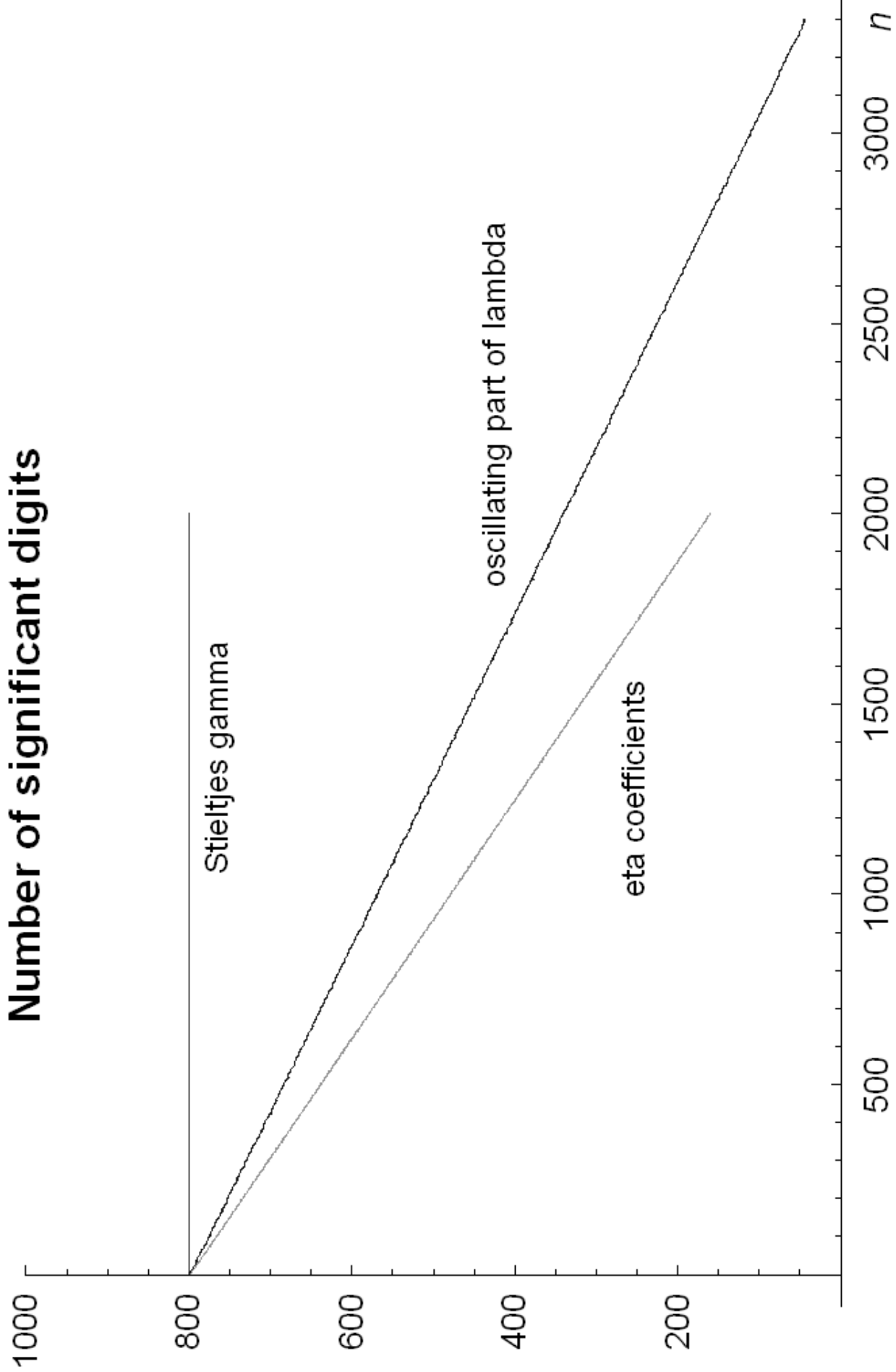

Figure 5.

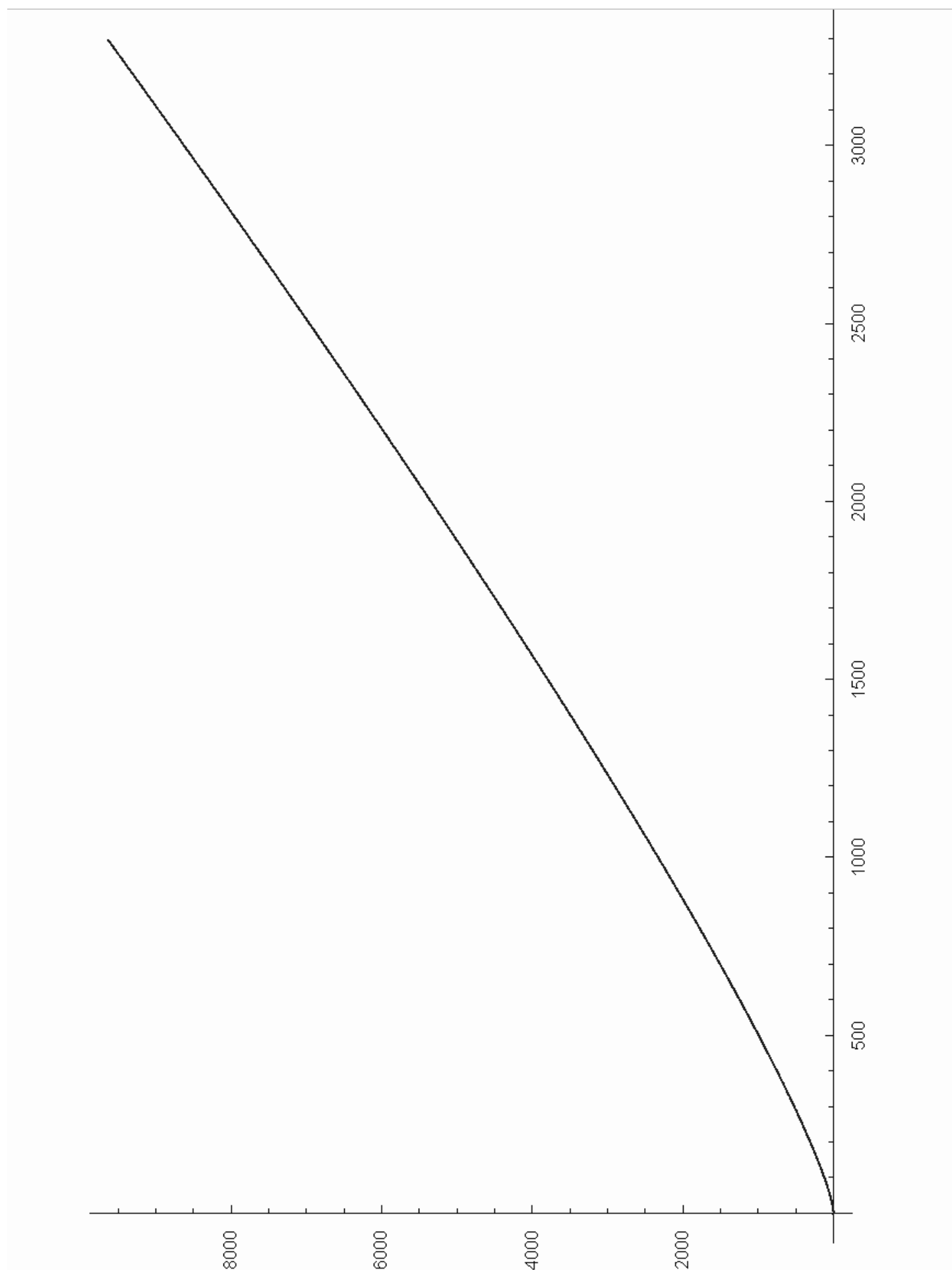

Figure 6 (upper part).

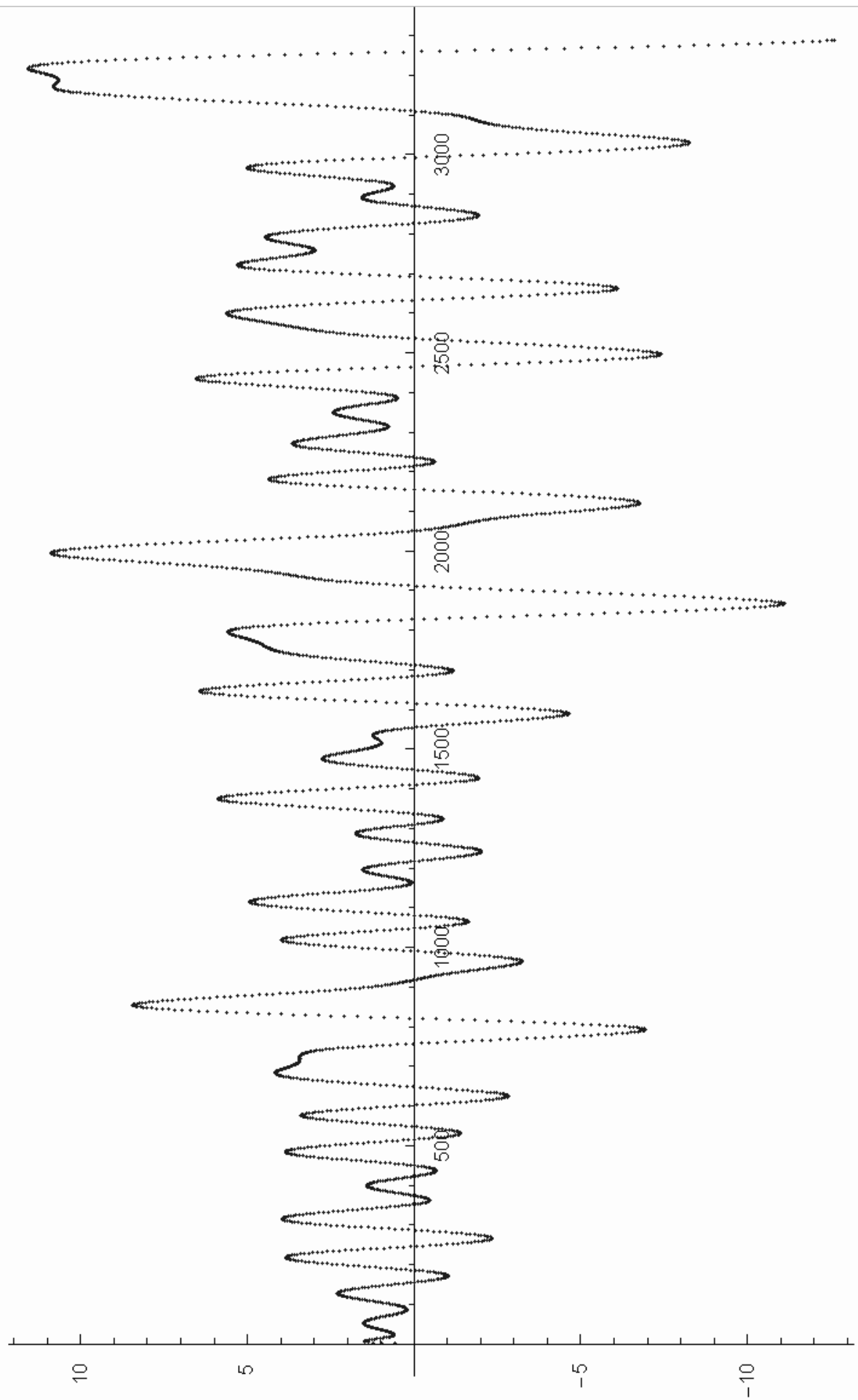

Figure 6 (lower part).

