

Spectral properties of the deformed Laplacian matrix of trees and H -join graphs

Roberto C. Díaz¹, Elismar R. Oliveira², Vilmar Trevisan²

¹*Departamento de Matemáticas, Universidad Católica del Norte,*

Avenida Angamos 0610, Antofagasta, Chile

`rdiaz01@ucn.cl`

²*Instituto de Matemática e Estatística, Universidade Federal do Rio Grande do Sul,*

Porto Alegre, Brasil

`elismar.oliveira@ufrgs.br`, `trevisan@mat.ufrgs.br`

Abstract

This paper investigates spectral properties of the deformed Laplacian matrix, which merges the Laplacian and signless Laplacian matrices of a graph through a one-parameter family of matrices. We present general results on the eigenvalues of these matrices for simple undirected graphs. Additionally, we analyze the spectrum of the deformed Laplacian in the specific cases of trees and H -join graphs. For trees, we derive strong results on the localization of eigenvalues, while for H -join graphs, we explicitly compute the spectrum of the deformed Laplacian.

MSC 2010: 05C50, 05C76, 05C35, 15A18.

Keywords: Graph operations, deformed Laplacian matrix, eigenvalues.

1 Introduction

The concept of the *deformed Laplacian* matrix was introduced by F. Morbidi in 2013 [11], within the context of a generalized continuous-time consensus protocol. In this framework, the traditional Laplacian matrix of the communication graph is replaced by a deformed version. The stability of this modified protocol is then analyzed by exploring the role of a real parameter s , using spectral theory techniques from quadratic eigenvalue problems, applied to both specific families of graphs (undirected and directed) and more general structures. Theoretical insights are supported by examples and simulations.

In a different but related direction, the authors of [5] proposed a novel centrality measure based on nonbacktracking walks — walks that avoid revisiting nodes in patterns such as uvu ,

where u and v are distinct adjacent vertices. This approach is argued to yield more informative rankings than traditional walk-based centralities. Interestingly, the authors demonstrate that this Katz-style centrality can be computed using a form of the deformed Laplacian matrix. Under certain conditions, this measure aligns with the nonbacktracking variant of eigenvector centrality introduced in a 2014 study.

Additionally, a distinct formulation of the deformed Laplacian appeared in [4], where the spectral properties of another variation were examined in the context of community detection in sparse networks. This highlights the versatility and growing relevance of deformed Laplacians across different applications in network science.

Let G be a simple undirected graph with n vertices. Denote by A its adjacency matrix, by D the diagonal degree matrix, and by I the $n \times n$ identity matrix. For a real scalar s , the deformed Laplacian matrix of G is defined as:

$$M_G(s) = I - sA + s^2(D - I)$$

$$= \begin{bmatrix} 1 + s^2(d_{v_1} - 1) & -sa_{12} & \cdots & -sa_{1\ n-1} & -sa_{1\ n} \\ -sa_{12} & 1 + s^2(d_{v_2} - 1) & \cdots & -sa_{2\ n-1} & -sa_{2\ n} \\ \vdots & \vdots & \ddots & \vdots & \vdots \\ -sa_{n-1\ 1} & -sa_{n-1\ 2} & \cdots & 1 + s^2(d_{v_{n-1}} - 1) & -sa_{n-1\ n} \\ -sa_{n\ 1} & -sa_{n\ 2} & \cdots & -sa_{n\ n-1} & 1 + s^2(d_{v_n} - 1) \end{bmatrix}. \quad (1)$$

The main objective of this paper is to explore the spectral properties of the deformed Laplacian matrix within a general graph-theoretical framework. While this matrix originally emerged in the context of consensus protocols in network dynamics, our aim is to study its mathematical structure from a broader spectral perspective. We focus, in particular, on the behavior of its eigenvalues and spectral radius, deriving specific and detailed results for classes of graphs such as trees. To achieve this, we employ eigenvalue localization techniques from [9], [7], and [13], which have proven to be powerful tools in the spectral analysis of symmetric matrices associated with graphs.

Our motivation is twofold. First, it stems from the growing interest in parametrized families of matrices that interpolate between classical graph matrices. A striking example is the work of V. Nikiforov [12], who introduced the A_α matrix of a graph, defined as $A_G(\alpha) := \alpha D(G) + (1 - \alpha)A(G)$, where $0 \leq \alpha \leq 1$. This formulation provides a smooth transition between the adjacency matrix $A(G)$ and the signless Laplacian $Q(G) = D(G) + A(G)$, and has opened new directions in spectral graph theory.

In a similar spirit, the deformed Laplacian matrix can be interpreted as a bridge between the standard Laplacian matrix $L = D - A$ and the signless Laplacian. This interpolation offers a promising avenue for generalizing and unifying spectral results associated with both matrices. Moreover, the structure of the deformed Laplacian reveals new algebraic features that may have applications not only in theoretical studies, but also in practical areas such as network robustness, centrality measures, and graph-based machine learning.

Therefore, our investigation aims not only to extend the theoretical understanding of this matrix, but also to contribute to the broader program of uncovering the interplay between combinatorial structure and spectral properties in graphs.

Part of this paper is also devoted to determining the spectrum of the deformed Laplacian matrix for graphs constructed via the H -join operation [2], applied to a family of regular graphs. This construction allows for the synthesis of complex graph topologies from simpler building blocks, making it a valuable tool for both theoretical investigations and practical applications. By exploiting the regularity of the constituent graphs and the structure imposed by the H -join, we are able to derive explicit expressions for the eigenvalues of the resulting deformed Laplacian matrix. These spectral characterizations not only enrich the theoretical understanding of the H -join operation in the context of deformed Laplacians, but also highlight the interplay between local regularity and global structure in determining spectral properties. The analytical results obtained in this section contribute to the broader effort of identifying graph classes for which the spectrum of the deformed Laplacian can be computed in closed form.

The structure of the paper is organized as follows: In Section 2, we review key definitions and notational conventions. Section 3 focuses on the spectral radius, showing that it does not increase when passing to subgraphs. In Section 4, we present general upper bounds for the spectral radius of the deformed Laplacian. Section 5 analyzes its behavior on trees, drawing parallels with classical Laplacian and signless Laplacian matrices in bipartite graphs. Section 6 concludes by determining the spectrum of the deformed Laplacian for H -join graphs.

2 Preliminaries

Let $G = (V(G), E(G))$ be a simple undirected graph of order n . Let us denote by $\sigma(M) = \{\lambda_1^{[m_1]}, \lambda_2^{[m_2]}, \dots, \lambda_r^{[m_r]}\}$, the spectrum (the multiset of eigenvalues) of a square matrix M , where m_i stands for the multiplicity of eigenvalues $\lambda_i, i = 1, \dots, r$. An eigenvalue of a matrix M will be denoted by $\lambda(M)$. Given two disjoint vertex graphs G_1 and G_2 , the *join* of G_1 and G_2 , denoted by $G = G_1 \vee G_2$, has a vertex set $V(G) = V(G_1) \cup V(G_2)$ and $E(G) = E(G_1) \cup E(G_2) \cup \{xy : x \in V(G_1), y \in V(G_2)\}$.

This join operation can be generalized as follows [1, 2]: Let $H = (V(H), E(H))$ be a graph of order r , with vertex set $V(H) = \{1, \dots, r\}$, and let $\{G_1, \dots, G_r\}$ be a set of pairwise vertex disjoint graphs. For $1 \leq i \leq r$, the vertex $i \in V(H)$ is assigned to the graph G_i . Now let G be the graph obtained from the graphs G_1, \dots, G_r and the edges connecting each vertex of G_i with all the vertices of G_j if and only if $ij \in E(H)$. That is, G is the graph with vertex set $V(G) = \bigcup_{i=1}^r V(G_i)$ and edge set

$$E(G) = \left(\bigcup_{i=1}^r E(G_i) \right) \cup \left(\bigcup_{ij \in E(H)} \{uv : u \in V(G_i), v \in V(G_j)\} \right).$$

This graph operation was introduced in [1] denominated H – join of the graphs G_1, \dots, G_r and denoted by

$$G = \bigvee_H \{G_i : 1 \leq i \leq r\}.$$

It is clear that if each G_i is a graph of order n_i , then the H – join obtained G is a graph of order $n = n_1 + n_2 + \dots + n_r$ (for more details on the H –join operation, see [15, 16]).

Returning to the deformed Laplacian matrix $M_G(s)$, it is easy to see that for a fixed graph G , $M_G(0) = I$, $M_G(1) = I - A + (D - I) = D - A = L(G)$ is the combinatorial Laplacian matrix of G and $M_G(-1) = I + A + (D - I) = D + A = Q(G)$ is the signless Laplacian matrix of G . As we shall see later, the intervals $(-1, 0)$, $(0, 1)$ and their complements play a very different role with respect to the spectral properties of the deformed Laplacian matrix. This motivates the following notation for s .

Definition 1 We say that $s \in \mathbb{R}$ is sub-Laplacian if $|s| < 1$. Analogously, s is super-Laplacian if $|s| > 1$. Given $\lambda > 1$ a real number, we say that s is adapted to λ if $\lambda > (1 + |s|)^2$.

We also notice that this is a symmetric matrix underlying the graph G , that is, a weighted matrix of G . Thus, we can use an algorithm to locate eigenvalues such as Diagonalize from [9] to study its eigenvalues when G is a tree. The Diagonalize algorithm is given below.

Input: matrix $M = (m_{ij})$ with underlying tree T
Input: Bottom up ordering v_1, \dots, v_n of $V(T)$
Input: real number x
Output: diagonal matrix $D = \text{diag}(d_1, \dots, d_n)$ congruent to $M + xI$

Algorithm Diagonalize(M, x)
 initialize $d_i := m_{ii} + x$, for all i
 for $k = 1$ to n
 if v_k is a leaf **then** continue
 else if $d_c \neq 0$ for all children c of v_k **then**
 $d_k := d_k - \sum \frac{(m_{ck})^2}{d_c}$, summing over all children of v_k
 else
 select one child v_j of v_k for which $d_j = 0$
 $d_k := -\frac{(m_{jk})^2}{2}$
 $d_j := 2$
 if v_k has a parent v_ℓ , remove the edge $\{v_k, v_\ell\}$.
 end loop

The following theorem summarizes the way in which the algorithm will be applied. Its proof is based on a property of matrix congruence known as Sylvester’s Law of Inertia, we refer to [7] for details.

Theorem 1 Let M be a symmetric matrix of order n that corresponds to a weighted tree T and let x be a real number. Given a bottom-up ordering of T , let D be the diagonal matrix produced by Algorithm Diagonalize with entries T and x . The following hold:

- (a) The number of positive entries in the diagonal of D is the number of eigenvalues of M (including multiplicities) that are greater than $-x$.
- (b) The number of negative entries in the diagonal of D is the number of eigenvalues of M (including multiplicities) that are less than $-x$.
- (c) The number of zeros in the diagonal of D is the multiplicity of $-x$ as an eigenvalue of M .

Example 1 Consider the star graph $T = K_{1,n}$. In order to locate the eigenvalue λ for the deformed Laplacian matrix $M_T(s)$, we use $\text{Diagonalize}(M_T(s), -\lambda)$ initialized as Figure 1.

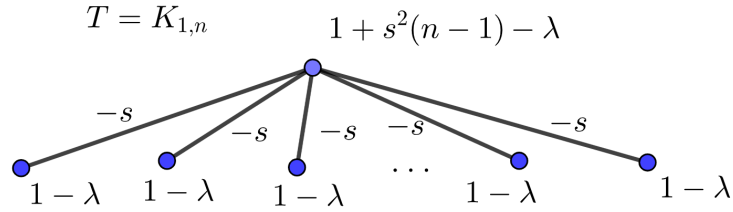

Figure 1: Initial values for the graph $K_{1,n}$.

For $\lambda = 1$ we get $n - 1$ zeros at the leafs and the pair $(2, -\frac{s^2}{2})$. According to Theorem 1 the spectrum is composed by $n - 1$ copies of $\lambda = 1$, an eigenvalue strictly smaller than 1 (so $\lambda = \lambda_{\min}$) and other strictly greater than $\lambda = 1$, the spectral radius (so $\lambda = \lambda_{\max} = \rho(M_T(s))$).

Applying the algorithm with an eigenvalue $\lambda \neq 1$ we obtain $1 - \lambda \neq 0$ in each leaf and the only zero must be the value at the root

$$1 + s^2(n - 1) - \lambda - \frac{ns^2}{1 - \lambda} = 0$$

whose solutions are

$$\lambda_{\max/\min} = \frac{1}{2} \left(s^2(n - 1) + 2 \pm s \sqrt{s^2(n - 1)^2 + 4n} \right)$$

the smaller is the minimum eigenvalue and the other is $\lambda = \rho(M_T(s))$ (associated to the signal +).

We denote by $d_n(s) := \frac{1}{n} \left(\sum_{i=1}^n \lambda_i(M_G(s)) \right)$, the average of the deformed Laplacian eigenvalues of a graph G . It is well known that if G is a graph on n vertices and m edges, then $\sum_{i=1}^n d_{v_i} = 2m$. Taking this into account, the following result follows.

Proposition 2 *Let G be a graph on n vertices and m edges. Then,*

$$d_n(s) = \frac{1}{n} \left(\sum_{i=1}^n \lambda_i(M_G(s)) \right) = 1 - s^2 + \bar{d}s^2,$$

where $\bar{d} = 2m/n$ is the average degree of G .

Proof From (1) we have that

$$\begin{aligned} \sum_{i=1}^n \lambda_i(M_T(s)) &= \text{tr}(M_T(s)) = \text{tr}(I - sA + s^2(D - I)) \\ &= n + s^2 \sum_{i=1}^n (d_{v_i} - 1) \\ &= n + 2ms^2 - ns^2 = (1 - s^2)n + 2ms^2. \end{aligned}$$

When we divide the latter by n , the result follows. \square

The average of the eigenvalues is a parameter of interest in spectral graph theory. For the combinatorial Laplacian (when $s = 1$), it is quite important to estimate the number of eigenvalues in certain intervals and is the main theme of several research papers. We notice that when $G = T$ is a tree, then $m = n - 1$ and the general result of Proposition 2 becomes

$$d_n(s) := \frac{1}{n} \left(\sum_{i=1}^n \lambda_i(M_G(s)) \right) = 1 + \frac{n-2}{n} s^2, \quad (2)$$

and, in particular, when $s = 1$, Equation (2) is specialized to $2 - \frac{2}{n}$. For years, it has been conjectured that most (at least half) of the eigenvalues of any tree of the combinatorial Laplacian are small, that is, smaller than the average $2 - \frac{2}{n}$. The proof of this result can be found in [8].

We note that the formula (2) is quite interesting since $\frac{n-2}{n} < 1$ means $d_n(s) \leq 1 + s^2$, and if $n \rightarrow \infty$ then $d_n(s) \rightarrow 1 + s^2$. Later, in Proposition 7 we will prove that if $T = T' \oplus P_2$ (a tree T' having a pendant path P_2) then $\rho(M_T(s)) > 1 + s^2$. Thus it is a very interesting question to predict how many eigenvalues are in the interval $[d_n, \rho(M_T(s))]$, denoted $\sigma(T)$. We notice that the only possibility for a tree having $\rho(M_T(s))$ close to $1 + s^2$ is it to be " P_n free" for $n \geq 2$, that is, for caterpillars, where the interval $[d_n, \rho(M_T(s))]$ will be very narrow. Again, by Proposition 7 we know that $\rho(M_T(s)) > 1 + \sqrt{3}|s| + s^2$ because $\Delta(T) = 3$, otherwise T will be a path. So, the length of the interval is at least $\rho(M_T(s)) - d_n > \sqrt{3}|s|$. We point out that for $s = \pm 1$ we obtain $d_n = 2 - 2/n$ and by [8] we know that $\sigma(T) \leq \lfloor \frac{n}{2} \rfloor$. Those and other related questions would be a subject of additional research.

3 The spectral radius of a subgraph

An expected property for a matrix that represents a graph is that the spectral radius of a subgraph is smaller than the spectral radius of the original graph. We prove that this property holds for the deformed Laplacian matrix, but not for all values of the parameter s . In the particular case of trees we will see that we can obtain a stronger claim, see Proposition 7.

Example 2 We point out that the deletion of one edge does not necessarily decrease the spectral radius of $M_G(s)$ for $0 < s < 1$. Consider, for instance, $s = \frac{3}{4}$ and G (see Figure 2) and G' the graph obtained from G by removing the edge $\{1, 2\}$. The adjacency matrix of G is

$$A = \begin{bmatrix} 0 & 1 & 1 & 1 & 1 \\ 1 & 0 & 1 & 0 & 1 \\ 1 & 1 & 0 & 1 & 0 \\ 1 & 0 & 1 & 0 & 1 \\ 1 & 1 & 0 & 1 & 0 \end{bmatrix}$$

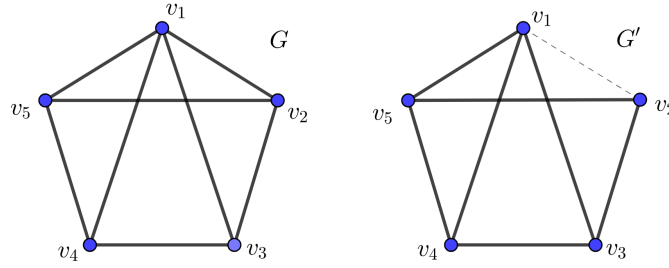

Figure 2: Graphs G (left) and G' (right).

A direct computation shows that $\rho(M_G(s)) = 3.6250000 < 3.6517332 = \rho(M_{G'}(s))$.

Let G' be an undirected simple graph obtained from G by removing the edge $\{v_1, v_2\}$. We now prove that if $s \in \mathbb{R} \setminus (1, 0)$, then $\rho(M_G(s)) \geq \rho(M_{G'}(s))$.

In this case the deformed Laplacian matrix is

$$M_{G'}(s) = \begin{bmatrix} 1 + s^2(d_{v_1} - 2) & 0 & \cdots & -sa_{1n-1} & -sa_{1n} \\ 0 & 1 + s^2(d_{v_2} - 2) & \cdots & -sa_{2n-1} & -sa_{2n} \\ \vdots & \vdots & \ddots & \vdots & \vdots \\ -sa_{n-11} & -sa_{n-12} & \cdots & 1 + s^2(d_{v_{n-1}} - 1) & -sa_{n-1n} \\ -sa_{n1} & -sa_{n2} & \cdots & -sa_{nn-1} & 1 + s^2(d_{v_n} - 1) \end{bmatrix}. \quad (3)$$

Taking into account (1) and (3), let us define the difference matrix

$$H(s) = M_G(s) - M_{G'}(s) = \begin{bmatrix} s^2 & -s & \cdots & 0 & 0 \\ -s & s^2 & \cdots & 0 & 0 \\ \vdots & \vdots & \ddots & \vdots & \vdots \\ 0 & 0 & \cdots & 0 & 0 \\ 0 & 0 & \cdots & 0 & 0 \end{bmatrix}. \quad (4)$$

The matrix H has some interesting properties, for instance, if $\mathcal{B} = \{e_1, \dots, e_n\}$ is the canonical basis of \mathbb{R}^n then

$$\begin{cases} He_1 = s^2 e_1 - s e_2 \\ He_2 = -s e_1 + s^2 e_2 \\ He_i = 0, i = 3, \dots, n \end{cases}$$

As a consequence $H(e_1 + e_2) = (s^2 - s)(e_1 + e_2)$ and $H(e_1 - e_2) = (s^2 + s)(e_1 - e_2)$. In particular $\mathcal{C} = \{u_1, u_2, e_3, \dots, e_n\}$ is an ortogonal basis consisting of eigenvectors of H , where, $u_1 = e_1 + e_2$ is associated with the eigenvalue $\lambda_1 = s^2 - s$ and $u_2 = e_1 - e_2$ is associated with the eigenvalue $\lambda_2 = s^2 + s$. Some useful relations are

$$\frac{\lambda_1 + \lambda_2}{2} = s^2 \quad \text{and} \quad \frac{\lambda_1 - \lambda_2}{2} = -s. \quad (5)$$

We now recall the Rayleigh quotient. If B is an $n \times n$ real symmetric matrix then

$$\rho(B) = \sup_{x \in \mathbb{R}^n / \{0\}} \frac{\langle x, Bx \rangle}{\langle x, x \rangle} = \sup_{\{x \in \mathbb{R}^n \mid |x|=1\}} \langle x, Bx \rangle. \quad (6)$$

Remark 1 Notice that if $|s| > 1$ then H is positive semidefinite, that is, $\langle x, Hx \rangle = x^T Hx \geq 0$.

Lemma 1 (Corollary 8.1.19 Horn and Johnson) Let A and B be two nonnegative matrices such that $0 \leq A \leq B$. Then, $\rho(A) \leq \rho(B)$.

Theorem 3 Let G be a undirected simple graph containing the edge $\{v_1, v_2\}$ and G' obtained from G by removing the edge $\{v_1, v_2\}$. If $s \in (-\infty, 0] \cup [1, +\infty)$, then

$$\rho(M_G(s)) \geq \rho(M_{G'}(s)).$$

Proof From Equation (6), we have

$$\begin{aligned} \rho(M_G(s)) &= \sup_{\{x \in \mathbb{R}^n \mid |x|=1\}} \{\langle x, M_G(s)x \rangle\} = \sup_{\{x \in \mathbb{R}^n \mid |x|=1\}} \{\langle x, (M_{G'}(s) + H)x \rangle\} \\ &= \sup_{\{x \in \mathbb{R}^n \mid |x|=1\}} \{\langle x, M_{G'}(s)x \rangle + \langle x, Hx \rangle\}. \end{aligned}$$

From Remark 1 we know that if $|s| \geq 1$ then $\lambda_1 = s^2 - s \geq 0$ and $\lambda_2 = s^2 + s \geq 0$ so the theorem follows for super-Laplacian values of s , because $\langle x, Hx \rangle \geq 0$ means $\rho(M_G(s)) \geq \rho(M_{G'}(s))$ in the above formula.

So we need to prove only the sub-Laplacian values of s , that is $-1 < s < 0$. In this situation, we always have $\lambda_1 = s^2 - s > 0$ and $\lambda_2 = s^2 + s < 0$. Thus $\langle x, Hx \rangle$ can change sign. However, notice that for $-1 < s < 0$ the matrix defined in (4) satisfies

$$H(s) = M_G(s) - M_{G'}(s) \geq 0.$$

Also, in (3), we have $0 \leq M_{G'}(s)$. Consequently, $0 \leq M_{G'}(s) \leq M_G(s)$. Therefore, from Lemma 1, it follows that $\rho(M_{G'}(s)) \leq \rho(M_G(s))$. \square

From Theorem 3 we can conclude the following result:

Corollary 1 *Let G be an undirected simple graph and let G' any subgraph of G . Then, $\rho(M_G(s)) \geq \rho(M_{G'}(s))$, for all $s \in (-\infty, 0] \cup [1, +\infty)$.*

4 Bounds for the spectral radius of the deformed Laplacian

We start with the following lower bound.

Theorem 4 *Let G be a simple, undirected and connected graph of order n with maximum degree Δ . If $s \in (-\infty, 0] \cup [1, +\infty)$, then*

$$\rho(M_G(s)) \geq \frac{1}{2} \left(s^2(\Delta - 1) + 2 + |s| \sqrt{s^2(\Delta - 1)^2 + 4\Delta} \right).$$

The equality holds if and only if $G \cong K_{1,n-1}$.

Proof It is known that the deformed Laplacian spectrum of a star (see Example 1) of order n is given by:

$$\sigma(K_{1,n}) = \left\{ \frac{1}{2} \left(s^2(n - 1) + 2 \pm s \sqrt{s^2(n - 1)^2 + 4n} \right), 1^{[n-1]} \right\}. \quad (7)$$

Since G has maximum degree Δ , $K_{1,\Delta}$ is a proper subgraph of G . From Corollary 1 and (7), it follows that

$$\rho(M_G(s)) \geq \rho(M_{K_{1,\Delta}}(s)) = \frac{1}{2} \left(s^2(\Delta - 1) + 2 + |s| \sqrt{s^2(\Delta - 1)^2 + 4\Delta} \right).$$

\square

We next provide the following upper bound.

Theorem 5 *Let G be a simple, undirected and connected graph of order n with maximum degree Δ . Let $M_G(s)$ be its deformed Laplacian matrix. Then,*

$$\rho(M_G(s)) \leq 1 + s^2(\Delta - 1) + |s| \rho(A(G)).$$

Proof Recall that $M_G(s) = I - sA + s^2(D - I)$. Thus,

$$\begin{aligned}\rho(M_G(s)) &\leq \sup_{|x|=1} \{|M_G(s)x|\} = \sup_{|x|=1} |(I - sA + s^2(D - I))x| \\ &\leq \sup_{|x|=1} |(I + s^2(D - I))x| + \sup_{|x|=1} |s||Ax| \\ &= 1 + s^2(\Delta - 1) + |s|\rho(A(G)),\end{aligned}$$

since $I + s^2(D - I)$ is a diagonal matrix and $\sup_{|x|=1} |Ax| = \rho(A(G))$, being A a symmetric matrix. □

5 Spectrum of deformed Laplacian associated to a tree

We start this section, with a result for the spectrum of the deformed Laplacian associated to a bipartite graph, which contains trees as a particular subcase.

Theorem 6 *If G is a bipartite graph, then $\sigma(M_G(s)) = \sigma(M_G(-s))$.*

Proof For $G = (V, E)$, let $V = V_1 \cup V_2$ the bipartition of V . We write

$$A = A(G) = \begin{pmatrix} 0 & B \\ B^T & 0 \end{pmatrix}$$

Let U be the diagonal matrix defined as follows:

$$u_{i,i} = \begin{cases} 1 & \text{if } v_i \in V_1 \\ -1 & \text{if } v_i \in V_2. \end{cases}$$

It is easy to see that $U = U^{-1}$ and also $UAU^{-1} = -A$. Let us now write

$$M_1 = M_G(s) = I + s^2(D - I) - sA \quad \text{and} \quad M_2 = M_G(-s) = I + s^2(D - I) + sA.$$

Then,

$$\begin{aligned}UM_1U^{-1} &= U(I + s^2(D - I) - sA)U^{-1} \\ &= UU^{-1} + s^2UU^{-1}(D - I) - sUAU^{-1} \\ &= I + s^2(D - I) - s(-A) = M_2.\end{aligned}$$

It follows then that M_1 and M_2 are similar matrices, and therefore have the same spectrum. □

Remark 2 It is well known in the literature that when G is a bipartite graph, the Laplacian matrix $L(G)$ and the signless Laplacian matrix $Q(G)$ are cospectral. This can be seen as a particular case of Theorem 6 as follows:

$$\sigma(Q(G)) = \sigma(M_G(1)) = \sigma(M_G(-1)) = \sigma(L(G)).$$

We now give some results about the spectrum of the deformed Laplacian matrix $M_T(s)$ underlying a tree T . In particular, the Proposition 7 5) strengthens the result in Theorem 3, for general graphs, showing that for every value of s the spectral radius of sub trees does not increase.

Proposition 7 *Let $T \neq K_1$ be a tree and let $M_T(s)$ be its deformed Laplacian matrix. Then*

- 1) $0 \in \text{Spect}(M_T(s))$ if and only if $s = \pm 1$;
- 2) $M_T(s)$ is positive definite if and only if $|s| < 1$;
- 3) $\rho(M_T(s)) > 1$;
- 4) If T has a pendant P_2 then $\rho(M_T(s)) > 1 + s^2$;
- 5) Let v be a pendant vertex of a tree T . If $T' = T \setminus v$ then $\rho(M_{T'}(s)) < \rho(M_T(s))$. In particular, if T' is a subtree of T , then $\rho(M_{T'}(s)) < \rho(M_T(s))$;
- 6) If $\Delta(T) \geq 4$, then $\rho(M_T(s)) > 1 + 2|s| + s^2$ (analogously, $\rho(M_T(s)) > 1 + \sqrt{3}|s| + s^2$ if $\Delta(T) \geq 3$);
- 7) If T is a starlike tree $T := [q_1, \dots, q_k]$ then $\rho(M_T(s)) \leq 1 + s^2(\Delta(T) - 1) + |s|\frac{k}{\sqrt{k-1}}$.

Proof

1. We perform the algorithm $\text{Diag}(M_T(s), 0)$. Initializing T with the corresponding values we see that in each pendant star with central vertex u we obtain the value $1 + s^2(\deg(u) - 1) - 1$, $-s$ in the edges and 1 in each leaf. The first stage updates the value in u as

$$1 + s^2(\deg(u) - 1) - (\deg(u) - 1)\frac{(-s)^2}{1} = 1.$$

At the last vertex (the root) we obtain

$$1 + s^2 \deg(u) - (\deg(u) - 1)\frac{(-s)^2}{1} = 1 - s^2.$$

Thus, 0 is an eigenvalue of $M_T(s)$ if and only if $s = \pm 1$ and all the other eigenvalues of the deformed Laplacian are greater than 0.

2. Observe that if $|s| < 1$, then all output values of the algorithm are positive, which means that all eigenvalues are greater than 0.

3. Consider $\lambda = \rho(M_T(s))$. When performing the algorithm $Diag(M_T(s), -\lambda)$, each leaf is initialized with $1 - \lambda \leq 0$ because we are using the spectral radius and by Theorem 1 all the values must be negative. Moreover, if $1 - \lambda = 0$ and since $T \neq K_1$, then that leaf should receive the value 2 and the next vertex receives $\frac{-s^2}{2}$. However, a positive output means that there is an eigenvalue greater than λ , which is absurd since λ is the spectral radius. Thus $1 - \lambda < 0$ or $\lambda > 1$.
4. Consider $T = T' \oplus P_2$ (a tree with a pendant p_2 and $\lambda = \rho(M_T(s))$). When performing the algorithm $Diag(M_T(s), -\lambda)$, each leaf is initialized with $1 - \lambda < 0$, as we already proved. The next vertex in P_2 receives the value

$$1 + s^2(2 - 1) - \lambda - \frac{s^2}{1 - \lambda} < 0,$$

otherwise we reach a contradiction. Since $1 - \lambda < 0$, we obtain

$$1 + s^2 - \lambda < \frac{s^2}{1 - \lambda} < 0,$$

thus $\rho(M_T(s)) > 1 + s^2$.

5. Consider $T' = T \setminus v$, where T' has the joining vertex u as the root of T' . We know that for $\lambda = \rho(M_{T'}(s))$ we obtain

$$a_{T'}(u) = 1 + s^2(\deg_{T'}(u) - 1) - \lambda - \xi = 0$$

where ξ is the resulting value obtained by processing all the children of u in T' . On the other hand,

$$a_T(u) = 1 + s^2(\deg_T(u) - 1) - \lambda - \xi - \frac{s^2}{1 - \lambda} = a_{T'}(u) + s^2 + \frac{s^2}{\lambda - 1} > 0,$$

thus $\rho(M_T(s)) > \rho(M_{T'}(s))$.

6. If $\Delta(T) \geq 4$, then S_4 is a subtree of T and therefore $\rho(M_{S_4}(s)) < \rho(M_T(s))$. Let u be the root of S_4 and $\lambda = \rho(M_{S_4}(s))$. Then

$$a_{S_4}(u) = 1 + s^2(4 - 1) - \lambda - \frac{4s^2}{1 - \lambda} = 0.$$

Solving this equation for λ we get one positive root, given by

$$\lambda = \frac{3}{2}s^2 + 1 + \frac{1}{2}\sqrt{9s^4 + 16s^2} > 1 + s^2 + \frac{1}{2}4|s|\sqrt{\frac{9}{16}s^2 + 1} > 1 + s^2 + 2|s|.$$

7. If T is a starlike tree $T := [q_1, \dots, q_k]$, then we have from [10] that

$$\sqrt{k} \leq \rho_A(T) \leq \frac{k}{\sqrt{k-1}}.$$

The inequality follows from Theorem 5.

□

Example 3 Consider the tree $T = P_n$ and its deformed Laplacian matrix. Assume that $\lambda \geq \rho(M_{P_n}(s))$.

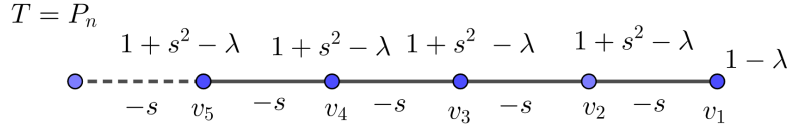

Figure 3: Graph P_n .

The output of the Eigenvalue Location Algorithm ($\text{Diag}(M_{P_n}(s), -\lambda)$) at each vertex of a path P_n (see Figure 3) gives a sequence Z_1, Z_2, \dots, Z_n defined by the recurrence relation

$$\begin{aligned} Z_1 &= 1 - \lambda \\ Z_j &= \varphi(Z_{j-1}), \text{ for } 2 \leq j \leq n-1, \end{aligned}$$

where $\varphi(t) = 1 + s^2 - \lambda - \frac{s^2}{t}$, for $t \neq 0$. Although, the last value processed in v_n is different because it has degree 1,

$$Z_n = 1 - \lambda - \frac{s^2}{Z_{n-1}}.$$

This equation provides an explicit formula for the spectral radius of the deformed Laplacian matrix associated to a path (and for starlike graphs) since Z_j can be explicitly computed from [13, Theorem 1] and the equation $Z_n = 0$ will be a simple rational expression on $\lambda = \rho(M_{P_n}(s))$ (the denominator is always non zero because all the previous Z_j must be negative).

The fixed points of φ , that is, the solutions of $\varphi(t) = t$ are the solutions $\theta(s)$ and $\theta'(s)$ of the quadratic equation

$$t^2 - (1 + s^2 - \lambda)t + s^2 = 0. \quad (8)$$

The most interesting case is when this equation has two distinct solutions, which happens when

$$\Delta(s) := (1 + s^2 - \lambda)^2 - 4s^2 > 0 \quad (9)$$

or, equivalently, $1 - \sqrt{\lambda} < s < -1 + \sqrt{\lambda}$. The solutions, in this case, are given by

$$\theta(s) := \frac{(1 + s^2 - \lambda) - \sqrt{(1 + s^2 - \lambda)^2 - 4s^2}}{2} \quad \text{and} \quad (10)$$

$$\theta'(s) := \frac{(1 + s^2 - \lambda) + \sqrt{(1 + s^2 - \lambda)^2 - 4s^2}}{2}. \quad (11)$$

It is obvious that $Z_1 = 1 - \lambda < 0$ if $\lambda \geq \rho(M_{P_n}(s))$ because $\rho(M_{P_n}(s)) > 1$, from Proposition 7, (3). In this case, $Z_1 < \theta$. Indeed, we have $1 - \lambda < \theta$ if and only if

$$2 - 2\lambda < 1 + s^2 - \lambda - \sqrt{(1 + s^2 - \lambda)^2 - 4s^2}$$

if and only if

$$\sqrt{(1 + s^2 - \lambda)^2 - 4s^2} < -1 + s^2 + \lambda,$$

which happens if and only if $-2\lambda s^2 < 2\lambda s^2$, which is true since $\lambda > 1$. Recall that, from Definition 1 in both sub-Laplacian or super-Laplacian cases, given a real number $\lambda > 1$, if s is adapted to λ then $\lambda > (1 + |s|)^2 = 1 + 2|s| + |s|^2$ so $1 - \sqrt{\lambda} < s < -1 + \sqrt{\lambda}$. This fact, combined with our estimates of the spectral radius of trees with minimum greater than 4 (Proposition 7, (6)), allows us to understand the behaviour of the deformed Laplacian eigenvalues associated to paths. More specifically, we observe that all Z_j are smaller than $\theta(s)$ because $Z_j \rightarrow \theta(s)$, increasingly, when $n \rightarrow \infty$ (see [13, Section 3.3] for details). This result can be used in several applications as consensus protocol or asymptotic behaviour of networks (that is, when we increase the number of vertices).

6 Spectrum of the deformed Laplacian associated to an H -join graph

Let H be a graph of order r and let $G = \bigvee_H \{G_i : 1 \leq i \leq r\}$ be the H -join graph. In this section, we consider the vertices of G with the labels $1, \dots, \sum_{i=1}^r n_i$, starting with the vertices of G_1 , continuing with the vertices of G_2, G_3, \dots, G_{r-1} and finally with the vertices of G_r .

Example 4 Let $H = P_3$, $G_1 = C_4$, $G_2 = P_2$, $G_3 = C_6$. The graph $G = \bigvee_H \{G_1, G_2, G_3\}$ is depicted in Figure 4, with vertex labels as described.

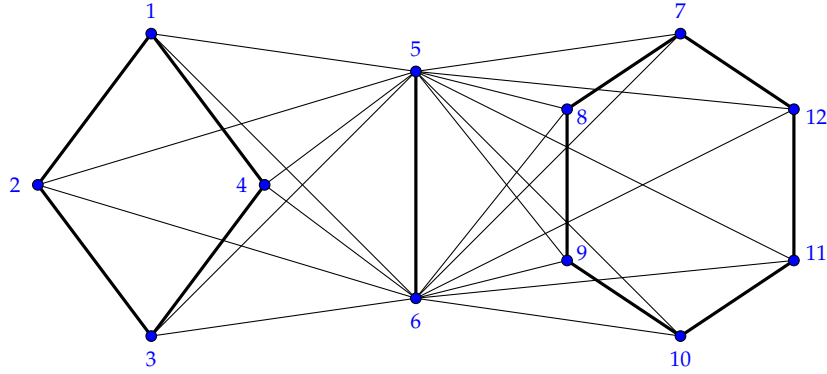

Figure 4. The graph $G = \bigvee_{P_3} \{C_4, P_2, C_6\}$.

With the above mentioned labeling, let

$$M(G) = \begin{bmatrix} M_1 & \delta_{12} \mathbf{1}_{n_1} \mathbf{1}_{n_2}^T & \dots & \delta_{1r} \mathbf{1}_{n_1} \mathbf{1}_{n_r}^T \\ \delta_{12} \mathbf{1}_{n_2} \mathbf{1}_{n_1}^T & M_2 & \ddots & \vdots \\ \vdots & \ddots & \ddots & \delta_{(r-1)r} \mathbf{1}_{n_{r-1}} \mathbf{1}_{n_r}^T \\ \delta_{1r} \mathbf{1}_{n_r} \mathbf{1}_{n_1}^T & \dots & \delta_{(r-1)r} \mathbf{1}_{n_r} \mathbf{1}_{n_{r-1}}^T & M_r \end{bmatrix}, \quad (12)$$

where the diagonal blocks M_i are symmetric matrices such that

$$M_i \mathbf{1}_{n_i} = \mu_i \mathbf{1}_{n_i}$$

for $i = 1, \dots, r$ and $\delta_{i,j}$ are scalars for $1 \leq i < j \leq r$. Let

$$F_r = \begin{bmatrix} \mu_1 & \delta_{12}\sqrt{n_1 n_2} & \dots & \delta_{1(r-1)}\sqrt{n_1 n_{r-1}} & \delta_{1r}\sqrt{n_1 n_r} \\ \delta_{12}\sqrt{n_1 n_2} & \mu_2 & \dots & \delta_{2(r-1)}\sqrt{n_2 n_{r-1}} & \delta_{2r}\sqrt{n_2 n_r} \\ \vdots & \vdots & \ddots & \vdots & \vdots \\ \delta_{1(r-1)}\sqrt{n_2 n_{r-1}} & \delta_{2(r-1)}\sqrt{n_2 n_{r-1}} & \dots & \mu_{r-1} & \delta_{(r-1)r}\sqrt{n_{r-1} n_r} \\ \delta_{1r}\sqrt{n_1 n_r} & \delta_{2r}\sqrt{n_2 n_r} & \dots & \delta_{(r-1)r}\sqrt{n_{r-1} n_r} & \mu_r \end{bmatrix}. \quad (13)$$

The authors in [3] obtain the spectrum of $M(G)$, when $G = \bigvee_H \{G_i : 1 \leq i \leq r\}$ as follows:

Theorem 8 Consider the matrix $M(G)$ (12) and the matrix F_r (13). Then the spectrum of $M(G)$ is

$$\sigma(M(G)) = \bigcup_{i=1}^r (\sigma(M_i) - \{\mu_i\}) \cup \sigma(F_r).$$

6.1 The deformed Laplacian spectrum for H-join of graphs

In this section, we assume that H is a connected graph of order r . From (12), we have that the deformed Laplacian matrix of the H -join $G = \bigvee_H \{G_i : 1 \leq i \leq r\}$, where G_i is a d_i -degree regular graph of order n_i , for each $i = 1, \dots, r$, is given as follows

$$M_G(s) = I - sA + s^2(D - I) = \begin{bmatrix} M_1(s) & \delta_{12}\mathbf{1}_{n_1}\mathbf{1}_{n_2}^T & \dots & \delta_{1r}\mathbf{1}_{n_1}\mathbf{1}_{n_r}^T \\ \delta_{12}\mathbf{1}_{n_2}\mathbf{1}_{n_1}^T & M_2(s) & \ddots & \vdots \\ \vdots & \ddots & \ddots & \delta_{(r-1)r}\mathbf{1}_{n_{r-1}}\mathbf{1}_{n_r}^T \\ \delta_{1r}\mathbf{1}_{n_r}\mathbf{1}_{n_1}^T & \dots & \delta_{(r-1)r}\mathbf{1}_{n_r}\mathbf{1}_{n_{r-1}}^T & M_r(s) \end{bmatrix}, \quad (14)$$

and from (13)

$$F_r(s) = \begin{bmatrix} \lambda_1(M_1(s)) & \delta_{12}\sqrt{n_1 n_2} & \dots & \delta_{1r}\sqrt{n_1 n_r} \\ \delta_{12}\sqrt{n_1 n_2} & \lambda_1(M_2(s)) & \ddots & \vdots \\ \vdots & \ddots & \ddots & \delta_{(r-1)r}\sqrt{n_{r-1} n_r} \\ \delta_{1r}\sqrt{n_1 n_r} & \dots & \delta_{(r-1)r}\sqrt{n_{r-1} n_r} & \lambda_1(M_r(s)) \end{bmatrix}, \quad (15)$$

where $\delta_{ij} = -s$ if $ij \in E(H)$ and $\delta_{ij} = 0$ otherwise.

Remark 3 Let $N_i = \sum_{j \in N_H(i)} n_j$, where $N_H(i)$ is the set of neighbors of vertex $i \in V(H)$. Taking into account (14), we note that

$$M_i(s) = \left(s^2(d_i + N_i - 1) + 1 \right) I_{n_i} - sA(G_i), \quad (16)$$

where I_{n_i} is the identity matrix of order n_i and $A(G_i)$ is the adjacency matrix of G_i , for each $i = 1, \dots, r$. Further, as G_i is a d_i -degree regular graph it follows that $M_i(s)\mathbf{1}_{n_i} = \lambda_1(M_i(s))\mathbf{1}_{n_i}$, where the eigenvalues $\lambda_1(M_i(s))$ (in (15)) are given by

$$\lambda_1(M_i(s)) = s^2(d_i + N_i - 1) - sd_i + 1, \quad i = 1, \dots, r. \quad (17)$$

We conclude that the spectrum of $M_i(s)$ is completely determined by the spectrum of $A(G_i)$, and is given as follows:

$$\sigma(M_i(s)) = \left\{ s^2(d_i + N_i - 1) - s\lambda_k(A(G_i)) + 1 \right\}_{k=1}^{n_i}, \quad (18)$$

with $\lambda_1(A(G_i)) = d_i$, for each $i = 1, \dots, r$.

Taking into account the Remark 3, by applying Theorem 8, we obtain our main result:

Theorem 9 Let H be a connected graph of order r . If for each $i \in \{1, \dots, r\}$, G_i is a d_i -degree regular graph of order n_i , then the spectrum of $M_G(s)$, where $G = \bigvee_H \{G_i : 1 \leq i \leq r\}$, is given by

$$\sigma(M_G(s)) = \bigcup_{i=1}^r \left(\sigma(M_i(s)) - \{\lambda_1(M_i(s))\} \right) \cup \sigma(F_r(s))$$

where $F_r(s)$, $\lambda_1(M_i(s))$ and $\sigma(M_i(s))$ are given as in (15), (17) and (18), respectively.

When $H = P_r$ or $H = C_r$, Theorem 9 allows us to obtain the following results:

Corollary 2 Let $H = P_r$. If for each $i \in \{1, \dots, r\}$, G_i is a d_i -degree regular graph of order n_i , then the spectrum of $M_G(s)$, where $G = \bigvee_{P_r} \{G_i : 1 \leq i \leq r\}$, is given by

$$\sigma(M_G(s)) = \bigcup_{i=1}^r \left(\sigma(M_i(s)) - \{\lambda_1(M_i(s))\} \right) \cup \sigma(F_r(s))$$

where $\lambda_1(M_i(s))$ and $\sigma(M_i(s))$ are given as in (17) and (18), respectively and $F_r(s)$ is the tridiagonal matrix given by

$$F_r(s) = \begin{bmatrix} \lambda_1(M_1(s)) & -s\sqrt{n_1 n_2} & & & & \\ -s\sqrt{n_1 n_2} & \lambda_1(M_2(s)) & -s\sqrt{n_2 n_3} & & & \\ & -s\sqrt{n_2 n_3} & \lambda_1(M_3(s)) & -s\sqrt{n_3 n_4} & & \\ & & -s\sqrt{n_3 n_4} & \ddots & \ddots & \\ & & & \ddots & \ddots & \\ & & & & \ddots & \ddots \\ & & & & & \lambda_1(M_{r-1}(s)) & -s\sqrt{n_{r-1} n_r} \\ & & & & & -s\sqrt{n_{r-1} n_r} & \lambda_1(M_r(s)) \end{bmatrix}.$$

Corollary 3 Let $H = C_r$. If for each $i \in \{1, \dots, r\}$, G_i is a d_i -degree regular graph, then the spectrum of $M_G(s)$, where $G = \bigvee_{C_r} \{G_i : 1 \leq i \leq r\}$, is given by

$$\sigma(M_G(s)) = \bigcup_{i=1}^r \left(\sigma(M_i(s)) - \{\lambda_1(M_i(s))\} \right) \cup \sigma(F_r(s))$$

where $\lambda_1(M_i(s))$ and $\sigma(M_i(s))$ are given as in (17) and (18), respectively and $F_r(s)$ is the periodic Jacobi matrix given by

$$F_r(s) = \begin{bmatrix} \lambda_1(M_1(s)) & -s\sqrt{n_1 n_2} & & & & & -s\sqrt{n_1 n_r} \\ -s\sqrt{n_1 n_2} & \lambda_1(M_2(s)) & -s\sqrt{n_2 n_3} & & & & \\ & -s\sqrt{n_2 n_3} & \lambda_1(M_3(s)) & -s\sqrt{n_3 n_4} & & & \\ & & -s\sqrt{n_3 n_4} & \ddots & \ddots & & \\ & & & \ddots & \ddots & & \\ & & & & \ddots & \ddots & \\ & & & & & \lambda_1(M_{r-1}(s)) & -s\sqrt{n_{r-1} n_r} \\ -s\sqrt{n_1 n_r} & & & & & -s\sqrt{n_{r-1} n_r} & \lambda_1(M_r(s)) \end{bmatrix}.$$

6.1.1 Some particular cases of Corollary 2

It is well known that the determinant of a symmetric tridiagonal matrix A of order n satisfies the following recurrence relation:

$$f_n = |A| = \begin{vmatrix} a_1 & b_1 & 0 & \cdots & 0 \\ b_1 & a_2 & b_2 & \ddots & \vdots \\ 0 & b_2 & a_3 & \ddots & 0 \\ \vdots & \ddots & \ddots & \ddots & b_{n-1} \\ 0 & \cdots & 0 & b_{n-1} & a_n \end{vmatrix} = a_n f_{n-1} - b_{n-1}^2 f_{n-2}, \quad (19)$$

where f_{n-1} and f_{n-2} are the determinants of the leading principal submatrices of A of order $n-1$ and $n-2$, respectively, with $f_0 = 1$.

Result 1 Let $H = P_3$. Let G_i be a d_i -regular graph of order n_i , $i = 1, 2, 3$. If $d_1 = d_3$ and $G = \bigvee_{P_3} \{G_1, G_2, G_3\}$, then

$$\sigma(M_G(s)) = \bigcup_{i=1}^3 \sigma(M_i(s)) \cup \left\{ \frac{1}{2} \left(a(s) + b(s) \pm \sqrt{(a(s) - b(s))^2 + 4s^2 n_2 (n_1 + n_3)} \right) \right\} - \{a(s), b(s)\},$$

where

$$a(s) = \lambda_1(M_1(s)) = s^2(d_1 + n_2 - 1) - sd_1 + 1,$$

$$b(s) = \lambda_1(M_2(s)) = s^2(d_2 + (n_1 + n_2) - 1) - sd_2 + 1$$

and $\sigma(M_i(s))$, $i = 1, 2, 3$, is given as in (18).

Proof Since $d_1 = d_3$, from (17), it follows that $a(s) = \lambda_1(M_1(s)) = \lambda_1(M_3(s))$. Therefore,

$$F_3(s) = \begin{bmatrix} a(s) & -s\sqrt{n_1 n_2} & 0 \\ -s\sqrt{n_1 n_2} & b(s) & -s\sqrt{n_2 n_3} \\ 0 & -s\sqrt{n_2 n_3} & a(s) \end{bmatrix}.$$

From (19), we have

$$\begin{aligned} |\lambda I - F_3(s)| &= (\lambda - a(s)) \begin{vmatrix} a(s) & -s\sqrt{n_1 n_2} \\ -s\sqrt{n_1 n_2} & b(s) \end{vmatrix} - s^2 n_2 n_3 (\lambda - a(s)) \\ &= (\lambda - a(s)) \left(\lambda^2 - (a(s) + b(s))\lambda + a(s)b(s) - s^2 n_2 (n_1 + n_3) \right). \end{aligned}$$

Consequently,

$$\sigma(F_3(s)) = \left\{ a(s), \frac{1}{2} \left(a(s) + b(s) \pm \sqrt{(a(s) - b(s))^2 + 4s^2 n_2 (n_1 + n_3)} \right) \right\}.$$

Thus, from Corollary 2, the proof follows. \square

Next, we illustrate Result 1 with the following example:

Example 5 Let $G = \bigvee_{P_3} \{C_4, P_2, C_6\}$ be the graph depicted in Example 4. Taking into account (18) and Result 1, we explicitly obtain the spectrum of $M_G(s)$ as follows:

$$\begin{aligned} \sigma(M_G(s)) &= \left\{ \frac{1}{2} \left(13s^2 - 3s + 2 \pm s\sqrt{49s^2 + 14s + 81} \right), 3s^2 - 2s + 1, \right. \\ &\quad \left. (3s^2 + 1)^{[4]}, (3s^2 + 2s + 1)^{[2]}, 10s^2 + s + 1, 3s^2 + s + 1, 3s^2 - s + 1 \right\}. \end{aligned}$$

Result 2 Let $H = P_4$. Let G_i be a d_i -regular graph of order n_i , $i = 1, 2$. Then the spectrum of $M_G(s)$, where $G = \bigvee_{P_4} \{G_1, G_2, G_2, G_1\}$, is given by

$$\sigma(M_G(s)) = \left(\sigma(M_1(s))^{[2]} - \{a(s)^{[2]}\} \right) \cup \left(\sigma(M_2(s))^{[2]} - \{b(s)^{[2]}\} \right) \cup \sigma(F_4(s)),$$

where $\sigma(M_i(s))^{[2]}$ means that each eigenvalue of $M_i(s)$, $i = 1, 2$, doubles its multiplicity and

$$\begin{aligned} \sigma(F_4(s)) &= \left\{ \frac{1}{2} \left(a(s) + b(s) + sn_2 \pm \sqrt{(a(s) - b(s) - sn_2)^2 + 4s^2 n_1 n_2} \right), \right. \\ &\quad \left. \frac{1}{2} \left(a(s) + b(s) - sn_2 \pm \sqrt{(a(s) - b(s) + sn_2)^2 + 4s^2 n_1 n_2} \right) \right\}, \end{aligned} \quad (20)$$

being

$$a(s) = \lambda_1(M_1(s)) = s^2(d_1 + n_2 - 1) - sd_1 + 1,$$

$$b(s) = \lambda_1(M_2(s)) = s^2(d_2 + (n_1 + n_2) - 1) - sd_2 + 1$$

and $\sigma(M_i(s))$, $i = 1, 2$, is given as in (18).

Proof Since $G = \bigvee_{P_4} \{G_1, G_2, G_2, G_1\}$, it follows that

$$F_4(s) = \begin{bmatrix} a(s) & -s\sqrt{n_1 n_2} & & \\ -s\sqrt{n_1 n_2} & b(s) & -sn_2 & \\ & -sn_2 & b(s) & -s\sqrt{n_1 n_2} \\ & & -s\sqrt{n_1 n_2} & a(s) \end{bmatrix}.$$

From (19), we have

$$\begin{aligned} |\lambda I - F_4(s)| &= (\lambda - a(s))f_3 - s^2 n_1 n_2 f_2 \\ &= (\lambda - a(s)) \left((\lambda - b(s))f_2 - s^2 n_2^2 (\lambda - a(s)) \right) - s^2 n_1 n_2 f_2 \\ &= f_2 \left((\lambda - a(s))(\lambda - b(s)) - s^2 n_1 n_2 \right) - s^2 n_2^2 (\lambda - a(s))^2 \\ &= \left((\lambda - a(s))(\lambda - b(s)) - s^2 n_1 n_2 \right)^2 - \left(sn_2(\lambda - a(s)) \right)^2, \end{aligned}$$

where f_3 and f_2 are the determinants of the leading principal submatrices of $\lambda I - F_4(s)$ of order 3 and 2, respectively. Consequently, $|\lambda I - F_4(s)| = 0$ if and only if

$$\lambda^2 - (a(s) + b(s) + sn_2)\lambda + a(s)b(s) + sn_2a(s) - s^2 n_1 n_2 = 0, \quad \text{or}$$

$$\lambda^2 - (a(s) + b(s) - sn_2)\lambda + a(s)b(s) - sn_2a(s) - s^2 n_1 n_2 = 0.$$

Thus, we find that the spectrum of $\sigma(F_4(s))$ is given by (21). From Corollary 2, the proof follows. \square

Example 6 Let $H = P_4$, $G_1 = P_2$ and $G_2 = C_3$. The graph $G = \bigvee_{P_4} \{P_2, C_3, C_3, P_2\}$ is depicted in Figure 5:

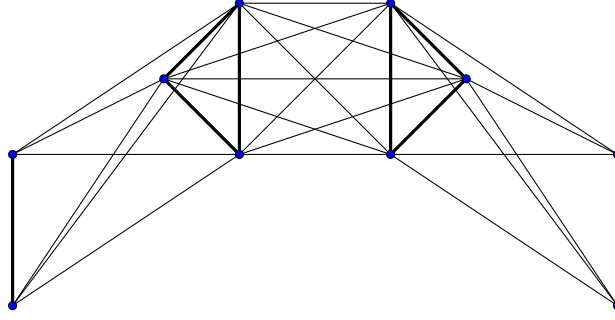

Figure 5. The graph $G = \bigvee_{P_4} \{P_2, C_3, C_3, P_2\}$.

Taking into account (18) and Result 2, we explicitly obtain the spectrum of $M_G(s)$ as follows:

$$\sigma(M_G(s)) = \left\{ \frac{1}{2} \left(9s^2 + 2 \pm s\sqrt{9s^2 + 12s + 28} \right), \frac{1}{2} \left(9s^2 - 6s + 2 \pm s\sqrt{9s^2 - 24s + 40} \right), \right. \\ \left. (3s^2 + s + 1)^{[2]}, (6s^2 - s + 1)^{[2]}, (6s^2 + s + 1)^{[2]} \right\}.$$

6.1.2 A particular case of Corollary 3

By proceeding with reasoning analogous to that used in Result 2, we get:

Result 3 Let $H = C_4$. Let G_i be a d_i -regular graph of order n_i , $i = 1, 2$. Then the spectrum of $M_G(s)$, where $G = \bigvee_{C_4} \{G_1, G_2, G_2, G_1\}$, is given by then

$$\sigma(M_G(s)) = \left(\sigma(M_1(s))^{[2]} - \{a(s)^{[2]}\} \right) \cup \left(\sigma(M_2(s))^{[2]} - \{b(s)^{[2]}\} \right) \cup \sigma(F_4(s)),$$

where $\sigma(M_i(s))^{[2]}$ means that each eigenvalue of $M_i(s)$, $i = 1, 2$, doubles its multiplicity and

$$\sigma(F_4(s)) = \left\{ \frac{1}{2} \left(a(s) + b(s) + s(n_1 + n_2) \pm \sqrt{(a(s) - b(s) + s(n_1 - n_2))^2 + 4s^2 n_1 n_2} \right), \right. \\ \left. \frac{1}{2} \left(a(s) + b(s) - s(n_1 + n_2) \pm \sqrt{(a(s) - b(s) - s(n_1 - n_2))^2 + 4s^2 n_1 n_2} \right) \right\}, \quad (21)$$

being

$$a(s) = \lambda_1(M_1(s)) = s^2(d_1 + n_2 - 1) - sd_1 + 1,$$

$$b(s) = \lambda_1(M_2(s)) = s^2(d_2 + (n_1 + n_2) - 1) - sd_2 + 1$$

and $\sigma(M_i(s))$, $i = 1, 2$, is given as in (18).

Example 7 Let $H = C_4$, $G_1 = P_2$ and $G_2 = C_3$. The graph $G = \bigvee_{C_4} \{P_2, C_3, C_3, P_2\}$ is depicted in Figure 6:

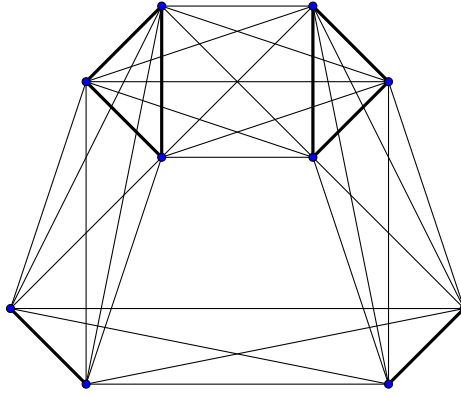

Figure 6. The graph $G = \bigvee_{C_4} \{P_2, C_3, C_3, P_2\}$.

Taking into account (18) and Result 3, we explicitly obtain the spectrum of $M_G(s)$ as follows:

$$\sigma(M_G(s)) = \left\{ \frac{1}{2} \left(9s^2 - 8s + 2 \pm s\sqrt{9s^2 - 12s + 28} \right), \frac{1}{2} \left(9s^2 + 2s + 2 \pm s\sqrt{27s^2 + 72} \right), \right. \\ \left. (3s^2 + s + 1)^{[2]}, (6s^2 - s + 1)^{[2]}, (6s^2 + s + 1)^{[2]} \right\}.$$

Acknowledgements.

The research of R. C. Díaz was supported by ANID Programa Fondecyt de Iniciación en Investigación 2024, N° 11240142, Chile. Elismar Oliveira and Vilmar Trevisan are partially supported by MATH-AMSUD under project GSA, financed by CAPES - process 88881.694479/2022-01, and by CNPq grant 408180/2023-4. Vilmar Trevisan also acknowledges the suport of CNPq grant 310827/2020-5.

References

- [1] D.M. Cardoso, M.A.A. de Freitas, E. Martins, M. Robbiano, Spectra of graphs obtained by a generalization of the join graph operation, *Discrete Mathematics* **313** (2013) 733–741.
- [2] D.M. Cardoso, E. Martins., M. Robbiano, O. Rojo, Eigenvalues of a H-generalized operation constrained by vertex subsets, *Linear Algebra Appl.* **438** (2013) 3278–3290.
- [3] D.M. Cardoso, R.C. Díaz, O. Rojo, Distance matrices on the H-join of graphs: A general result and applications, *Linear Algebra Appl.* **559** (2018) 34–53.
- [4] L. Dall’Amico, R. Couillet, N. Tremblay, Classification spectrale par la laplacienne deformee dans des graphes realistes, *GRETSI 2019 - XXVIIeme Colloque francophone de traitement du signal et des images*, (2019), Lille, France. hal-02153901.
- [5] P. Grindrod, D.J. Higham, V. Noferini, The deformed graph Laplacian and its applications to network centrality analysis, *SIAM Journal on Matrix Analysis and Applications* **39**, Issue 1 (2018) 310–341.
- [6] F. Harary, On the group of compositions of two graphs, *Duke Math. J.* **26** (1959) 29–34.
- [7] C. Hoppen, D.P. Jacobs, V. Trevisan, Locating eigenvalues in graphs: Algorithms and applications, *Springer Nature*, (2022).
- [8] D.P. Jacobs, E.R. Oliveira, V. Trevisan, Most Laplacian eigenvalues of a tree are small, *Journal of Combinatorial Theory, Series B*, **146** (2021) 1–33.
- [9] D.P. Jacobs, V. Trevisan, Locating the eigenvalues of trees, *Linear Algebra Appl.* **434** Issue 1, (2011), 81–88.
- [10] M. Lepovi, I. Gutman, Some spectral Properties of starlike trees, *Bulletin, Beograd*, **CXXII** Issue 26, (2001).
- [11] F. Morbidi, The deformed consensus protocol, *Automatica* **49**, Issue 10, (2013) 3049–3055.
- [12] V. Nikiforov, Merging the A-and Q-spectral theories, *Appl. Anal. Discrete Math.* **11** (2017) 81–107.
- [13] E.R. Oliveira, V. Trevisan, Applications of rational difference equations to spectral graph theory, *J. Difference Equ. Appl.* **27**, Issue 7 (2021), 1024–1051.
- [14] G. Sabiduss, The composition of graphs, *Duke Math. J.* **26** (1959) 693–696.
- [15] A.J. Schwenk, Computing the characteristic polynomial of a graph, *Graphs and Combinatorics (Lecture notes in Mathematics 406, eds. R. Bary and F. Harary)*, Springer-Verlag, Berlin-Heidelberg-New York (1974), 153–172.

- [16] D. Stevanović, Large sets of long distance equienergetic graphs, *Ars Math. Contemp.* **2** (2009) 35–40.
- [17] D. Stevanović, Bounding the largest eigenvalue of trees in terms of the largest vertex degree, *Linear Algebra Appl.* **360**, (2003), 35–42.